



**Hidrotema**



**Hidrotema**

# 1. SAFETY PRECAUTIONS

The user, through its own analysis and testing, is solely responsible for determining the suitability of Taimi products for his own usage. The user must also assure compatibility of the swivel's seals with the fluid used. Never modify or weld on a Taimi product. Taimi products should never be used as structural or load bearing components. Always design all systems and equipment in a fail-safe mode, so that failure will not endanger persons or property.

## MAXIMUM WORKING PRESSURE - CARTRIDGES & STANDARD SERIES

SIZES	PSI	Bar
06 - 08 - 10 - 12 - 16	6250	430
20	5600	386
24	4500	310
32	3000	205

## MAXIMUM WORKING PRESSURE - 90° SHORT SERIES SWIVELS

SIZES	PSI	Bar
06 - 08	5000	345
12	4000	276
16	3500	241
20	2500	172

When assembling or doing maintenance on hydraulic systems and hose assemblies, it is of uttermost importance to be properly trained, use appropriate tools, components and equipment, follow specifications and think safety. Failure to follow safety precautions or improper product use can cause death, personal injury and property damage. Always relieve pressure before dismantling hydraulic lines.

Pressure capabilities of Taimi products must be respected. Temperatures below and above the recommended limit can affect seals to a point where a failure may occur and pressurized fluid be released.

Seals deteriorate over time and should be replaced at specific intervals, based on previous service life, fluid used and industry recommendations, or when failures could result in unacceptable downtime, damage, or injury risk. Only use Taimi original seals. It is important to assemble Taimi cartridges according to the torque charts. If Taimi cartridges are overtorqued, a housing failure may happen over time causing serious injuries or death. An undertorqued cartridge may dismantle causing serious injuries or death. Visually inspect your Taimi products for evidence of leakage, wear, or damage. Replace damaged products immediately.



**WARNING :** This product can expose you to chemicals including cobalt, which is known to the State of California to cause cancer. For more information, go to [www.P65warnings.ca.gov](http://www.P65warnings.ca.gov)





## 2. TECHNOLOGY

Taimi's unique ball-less swivel products bring reliability to your hydraulic systems, increasing service life and cutting out leakages. This translates in higher productivity and lower operating costs.

Our exclusive shank-nut assembly (cartridge) is the key to the effectiveness of our design.

The long span of the shank and the large contact surfaces allow for optimal load distribution. The slick thrust washer is built out of a self-lubricating polymer yielding low friction performance and excellent shock absorption characteristics.

- (A) The sturdy nut securely fastens the rotating shank to a housing, a block or a manifold, and prevents it from ever dismantling during operation.
- (B) Superior sealing is achieved in 3 stages; first by two (2) sets of oversized Viton o-rings and Teflon backups and by the contact under pressure on our thrust washer, effectively protecting against pressure spikes, for an unmatched reliability.

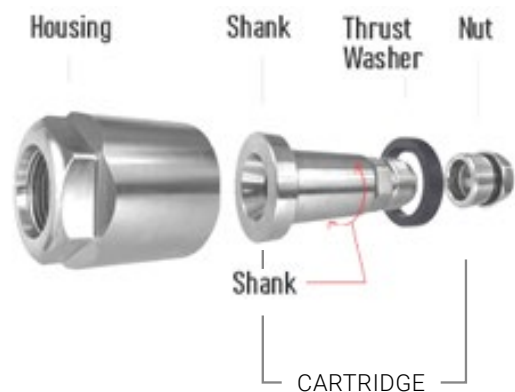

IMPULSE CYCLES TO FAILURE (INDEPENDANT TEST)

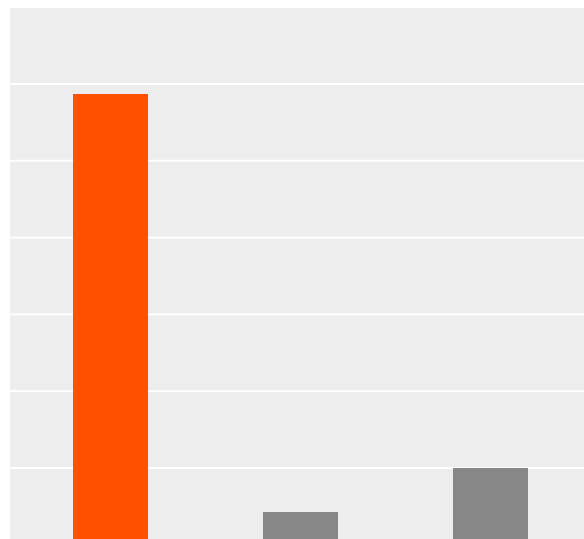

### 3. RESEARCH & DEVELOPMENT

Our technical staff works together with manufacturers, users, and machine operators. We develop our products to meet their needs.

We offer in-person and remote support to design and test new applications that meet your specific requirements. Technical drawings of our applications are available upon request.

**CONTACT US TO DISCUSS YOUR SPECIFIC NEEDS AND THE POSSIBILITY OF MANUFACTURING A CUSTOM SOLUTION.**

Our promises are to help you improve your productivity, reduce your operating costs, and help protect the environment by reducing leakage.

**WE ARE GUIDED BY THESE VALUES :**

**INNOVATION**

**EXCELLENCY**

**COLLABORATION**

**CLIENT SATISFACTION**

**SUSTAINABILITY**







## 4. CARTRIDGE SWIVELS

The Cartridge Swivel is designed to be integrated into hydraulic manifolds. It simply screws in, becoming a short and very sturdy swivel port that will live through high pressure and side loads.

### WHY CHOOSE TAIMI CARTRIDGE SWIVELS ?

- **Pressure Spikes Protection™**
- **Easy and quick to repack**
- **Triple Seal Protection™**
- **Patented ball-less design**
- **Cannot be pulled apart**
- **Less expensive than a stand alone hose swivel**
- **Easy integration**
- **Custom solutions available**
- **Technical support**



**Hidrotema**



# THE TOUGHEST SWIVEL PRODUCTS ON THE MARKET

## HOW TO ORDER

<b>SZ4</b>	<b>12</b>	<b>J</b>	<b>01</b>	<b>M</b>
<b>CARTRIDGE SWIVEL DESIGNATOR</b>	<b>HOSE CONNECTION SIZE</b>	<b>HOSE CONNECTION TYPE</b>  J = JIC (37°) F = NPT P = BSPP S = ORFS M = Metric	<b>ASSEMBLY NUMBER</b>	<b>SHANK CONFIGURATION</b>  M = MALE

Part numbers in orange  
are usually in stock.

Other products are  
manufactured to order.



## SIDE FEED CARTRIDGE MALE JIC - 37° FLARE

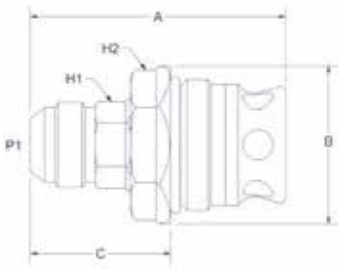

PART NU.	A	B	C	P1	H1	H2	SEAL KIT
SZ4-12-J10M	3.19"	1.97"	1.75"	1 1/16"-12 UN	15/16"	1 5/8"	SZ-12-110SK-A
SZ4-16-J10M	3.47"	2.22"	1.94"	1 5/16"-12 UN	1 3/16"	1 7/8"	SZ-16-110SK-A

## MALE JIC - 37° FLARE

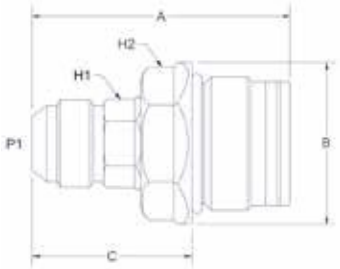

PART NU.	A	B	C	P1	H1	H2	SEAL KIT
SZ4-06-J01M	1.99"	1.22"	1.21"	9/16"-18 UNF	1/2"	1"	SZ-06-001SK-A
SZ4-08-J01M	2.53"	1.47"	1.56"	3/4"-16 UNF	11/16"	1 1/4"	SZ-08-001SK-A
SZ4-10-J01M	2.59	1.72	1.63	7/8"-14 UNF	13/16"	1 1/2"	SZ-10-001SK-A
SZ4-12-J01M	3.15"	1.97"	1.95"	1 1/16"-12 UN	15/16"	1 5/8"	SZ-12-001SK-A
SZ4-16-J01M	3.63"	2.22"	2.38"	1 5/16"-12 UN	1 3/16"	1 7/8"	SZ-16-001SK-A
SZ4-20-J01M	3.96"	2.75"	2.55"	1 5/8"-12 UN	1 1/2"	2 3/8"	SZ-20-001SK-A
SZ4-24-J01M	4.17"	2.97"	2.68"	1 7/8"-12 UN	1 3/4"	2 1/2"	SZ-24-001SK-A
SZ4-32-J01M	5.03"	3.88"	3.28"	2 1/2"-12 UN	2 5/16"	3 1/4"	SZ-32-001SK-A

## MALE PIPE (NPT)

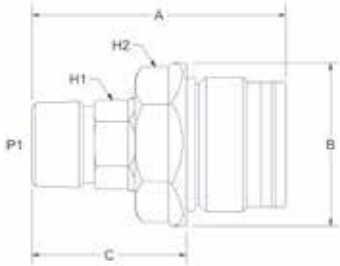

PART NU.	A	B	C	P1	H1	H2	SEAL KIT
SZ4-06-F01M	1.93"	1.35"	1.17"	3/8" NPT	5/8"	1 1/8"	SZ-06-002SK-A
SZ4-08-F01M	2.38"	1.53"	1.41"	1/2" NPT	3/4"	1 5/16"	SZ-08-002SK-A
SZ4-12-F01M	3.06"	1.97"	1.86"	3/4" NPT	15/16"	1 5/8"	SZ-12-001SK-A
SZ4-16-F01M	3.25"	2.22"	2.00"	1" NPT	1 3/16"	1 7/8"	SZ-16-001SK-A
SZ4-20-F01M	3.63"	2.72"	2.22"	1 1/4" NPT	1 1/2"	2 3/8"	SZ-20-001SK-A

## MALE BSPP

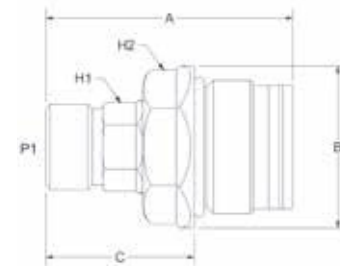

PART NU.	A	B	C	P1	H1	H2	SEAL KIT
SZ4-08-P01M	2.36"	1.53"	1.39"	G 1/2	3/4"	1 5/16"	SZ-08-002SK-A
SZ4-12-P01M	3.00"	1.97"	1.86"	G 3/4	15/16"	1 5/8"	SZ-12-001SK-A
SZ4-16-P01M	3.50"	2.22"	2.25"	G 1	1 3/16"	1 7/8"	SZ-16-001SK-A
SZ4-20-P01M	3.63"	2.72"	2.25"	G 1 1/4	1 1/2"	2 3/8"	SZ-20-001SK-A



## MALE ORFS (O-RING FACE SEAL / FLAT FACE O-RING)

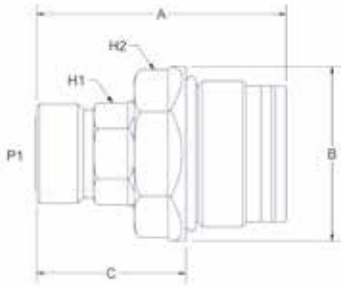

PART NU.	A	B	C	P1	H1	H2	SEAL KIT
SZ4-06-S01M	1.83"	1.35"	1.07"	11/16" - 16 UNF	5/8"	1 1/8"	SZ-06-002SK-A
SZ4-08-S01M	2.41"	1.53"	1.44"	13/16" - 16 UNF	3/4"	1 5/16"	SZ-08-002SK-A
SZ4-10-S01M	2.51"	1.86"	1.55"	1" - 14 UNF	15/16"	1 5/8"	SZ-10-002SK-A
SZ4-12-S01M	3.06"	2.09"	1.86"	1 3/16" - 12 UN	1 1/16"	1 3/4"	SZ-12-002SK-A
SZ4-16-S01M	3.50"	2.31"	2.25"	1 7/16" - 12 UN	1 5/16"	2"	SZ-16-002SK-A
SZ4-20-S01M	3.69"	2.72"	2.29"	1 11/16" - 12 UN	1 9/16"	2 3/8"	SZ-20-002SK-A
SZ4-24-S01M	3.91"	3.19"	2.42"	2.00" - 12 UN	1 7/8"	2 3/4"	SZ-24-002SK-A

## MALE METRIC ( DIN 3852 )

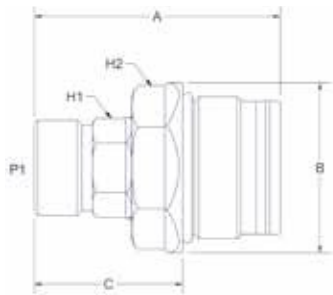

PART NU.	A	B	C	P1	H1	H2	SEAL KIT
SZ4-20S-M01M	2.38"	1.53"	1.43"	M20 X 1,5	3/4"	1 5/16"	SZ-08-002SK-A
SZ4-24S-M01M	2.56"	1.86"	1.57"	M24 X 1.5	15/16"	1 5/8"	SZ-10-002SK-A
SZ4-30S-M01M	3.03"	2.09"	1.83"	M30 X 2.0	1 1/16"	1 3/4"	SZ-12-002SK-A
SZ4-36S-M01M	3.46"	2.41"	2.21"	M36 X 2.0	1 5/16"	2"	SZ-16-002SK-A
SZ4-42S-M01M	3.72"	2.72"	2.32"	M42 X 2.0	1 9/16"	2 3/8"	SZ-20-002SK-A





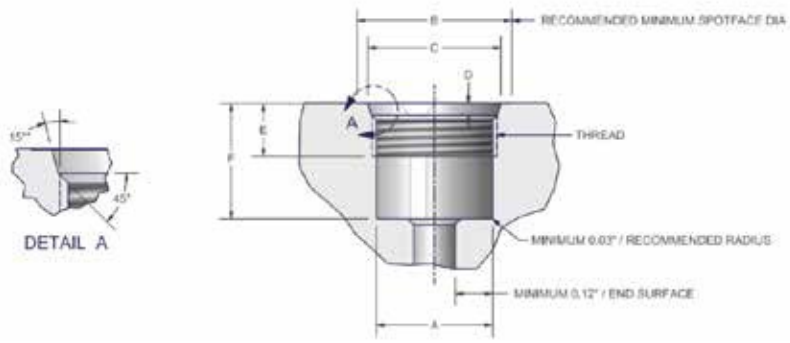

## CARTRIDGES BORING DIMENSIONS CHART

DIMENSIONS IN INCHES

SIZES & CONFIGURATION	A	B	C	D	E	F	THREAD
J06	0.920"- 0.925"	1.28"	1.068"-1.073"	0.100"-0.105"	0.50"-0.53"	0.800"-0.810"	1.00" - 12 UN - 1B
P06, S06, M18, F06	1.045"- 1.050"	1.38"	1.183"-1.188"	0.100"-0.105"	0.50"-0.53"	0.800"-0.810"	1.12" - 12 UN - 1B
J08	1.170"-1.175"	1.53"	1.310"-1.315"	0.100"-0.105"	0.69"-0.72"	1.000"-1.010"	1.25" - 12 UN - 1B
P08, S08, M20, F08	1.235"-1.240"	1.56"	1.373"-1.378"	0.100"-0.105"	0.69"-0.72"	1.000"-1.010"	1.31" - 12 UN - 1B
J10, P10, F10	1.355"-1.360"	1.78"	1.520"-1.525"	0.100"-0.105"	0.69"-0.72"	1.000"-1.010"	1.44" - 12 UN - 1B
S10, M24	1.490"-1.495"	1.94"	1.645"-1.650"	0.125"-0.130"	0.69"-0.72"	1.000"-1.010"	1.56" - 12 UN - 1B
J12, P12, F12	1.545"-1.550"	2.03"	1.690"-1.695"	0.125"-0.130"	0.81"-0.84"	1.235"-1.245"	1.63" - 12 UN - 1B
S12, M30	1.670"-1.675"	2.13"	1.860"-1.865"	0.125"-0.130"	0.81"-0.84"	1.235"-1.245"	1.75" - 12 UN - 1B
J16, P16, F16	1.795"-1.800"	2.25"	1.940"-1.945"	0.125"-0.130"	0.81"-0.84"	1.285"-1.295"	1.88" - 12 UN - 1B
S16, M36	1.915"-1.920"	2.38"	2.107"-2.112"	0.125"-0.130"	0.81"-0.84"	1.285"-1.295"	2.00" - 12 UN - 1B
J20, P20, S20, M42, F20	2.295"-2.300"	2.78"	2.430"-2.435"	0.125"-0.130"	1.00"-1.03"	1.440"-1.450"	2.38" - 12 UN - 1B
J24, F24	2.545"-2.550"	3.03"	2.690"-2.695"	0.125"-0.130"	1.00"-1.03"	1.530"-1.540"	2.63" - 12 UN - 1B
S24	2.660"-2.665"	3.21"	2.815"-2.820"	0.125"-0.130"	1.00"-1.03"	1.530"-1.540"	2.75" - 12 UN - 1B
J32, F32	3.295"-3.300"	3.94"	3.460"-3.465"	0.125"-0.130"	1.12"-1.15"	1.790"-1.800"	3.38" - 12 UN - 1B

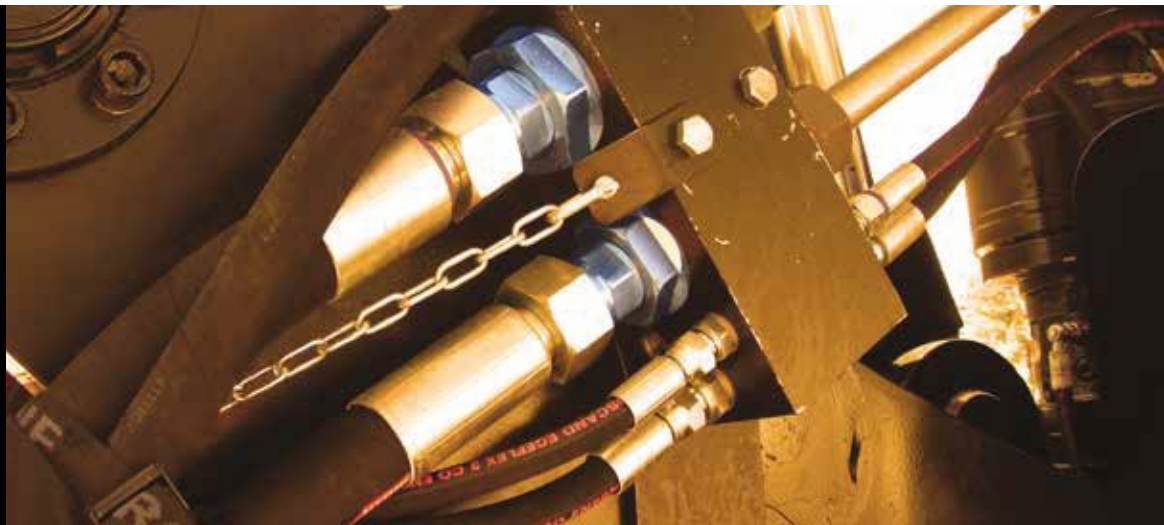

# CARTRIDGES BORING DIMENSIONS CHART

## METRIC DIMENSIONS

SIZES & CONFIGURATION	A	B	C	D	E	F	THREAD
J06	23.368-23.495	32.5	27.127-27.254	2.540-2.667	12.7-13.46	20.32-20.57	1.00" - 12 UN - 1B
P06, S06, M18, F06	26.543-26.670	35.0	30.048-30.175	2.540-2.667	12.7-13.46	20.32-20.57	1 1/8" - 12 UN - 1B
J08	29.718-29.845	38.9	33.274-33.401	2.540-2.667	17.53-18.29	25.40-25.65	1 1/4" - 12 UN - 1B
P08, S08, M20, F08	31.369-31.496	39.7	34.874-35.001	2.540-2.667	17.53-18.29	25.40-25.65	1 5/16" - 12 UN - 1B
J10, P10, F10	34.417-34.544	45.2	38.608-38.735	2.540-2.667	17.53-18.29	25.40-25.65	1 7/16" - 12 UN - 1B
S10, M24	37.846-37.973	49.3	41.783-41.910	3.175-3.302	17.53-18.29	25.40-25.65	1 9/16" - 12 UN - 1B
J12, P12, F12	39.243-39.370	51.6	42.926-43.053	3.175-3.302	20.57-21.34	31.37-31.62	1 5/8" - 12 UN - 1B
S12, M30	42.418-42.545	54.1	47.244-47.371	3.175-3.302	20.57-21.34	31.37-31.62	1 3/4" - 12 UN - 1B
J16, P16, F16	45.593-45.720	57.2	49.276-49.403	3.175-3.302	20.57-21.34	32.64-32.90	1 7/8" - 12 UN - 1B
S16, M36	48.641-48.768	60.5	53.518-53.645	3.175-3.302	20.57-21.34	32.64-32.90	2.00" - 12 UN - 1B
J20, P20, S20, M42, F20	58.293-58.420	70.6	61.722-61.849	3.175-3.302	25.40-26.16	36.58-36.83	2 3/8" - 12 UN - 1B
J24, F24	64.643-64.770	77.0	68.326-68.453	3.175-3.302	25.40-26.16	38.86-39.12	2 5/8" - 12 UN - 1B
S24	67.564-67.691	81.5	71.501-71.628	3.175-3.302	25.40-26.16	38.86-39.12	2 3/4" - 12 UN - 1B
J32, F32	83.693-83.820	100.0	87.884-88.011	3.175-3.302	28.45-29.21	45.47-45.72	3 3/8" - 12 UN - 1B

### SHANK INTERCHANGE

SIZES	JIC	BSPP	NPT	ORFS
06	X	✓	✓	✓
08	X	✓	✓	✓
10	✓	✓	na	X
12	✓	✓	✓	X
16	✓	✓	✓	X
20	✓	✓	✓	✓
24	✓	na	✓	na
32	✓	na	✓	na

### CARTRIDGE SWIVEL ASSEMBLY TORQUE

SIZES	FT-LBS	NM
06	125	170 Nm
08	215	290 Nm
10	300	405 Nm
12	390	530 Nm
16	490	665 Nm
20	800	1080 Nm
24	900	1215 Nm
32	1000	1350 Nm





# 5. IN-LINE SWIVELS

Taimi's patented ball-less swivels bring reliability to your hydraulic system increasing service life and cutting out leakages. This means higher productivity and lower operating costs. Taimi's swivels are the toughest on the market and are being chosen by some of the largest machinery manufacturers worldwide.

## WHY CHOOSE TAIMI IN-LINE SWIVELS?

- **Pressure Spikes Protection™**
- **Easy and quick to repack**
- **Triple Seal Protection™**
- **Patented ball-less design**
- **Cannot be pulled apart**
- **Withstand high pressures and harsh environments**
- **Custom solutions available**



**Hidrotema**



# HYDRAULIC PEACE OF MIND

Part numbers in orange  
are usually in stock.

Other products are  
manufactured to order

## HOW TO ORDER

SZ	J	12	M	J	12	M
SWIVEL DESIGNATOR	HOSE CONNECTION TYPE  J = JIC (37°) F = NPT P = BSPP S = ORFS M = Metric	SHANK SIZE	SHANK CONFIGURATION  M = MALE	HOUSING HOSE CONNECTION TYPE  J = JIC (37°) FLARE JB = COMBO JIC 37° FLARE - SAE (O-RING BOSS) F = NPT P = BSPP S = ORFS (O-RING FACE SEAL) M = METRIC	HOUSING  1/16 of an inch  M = MALE F = FEMALE	HOUSING CONFIGURATION  M = MALE F = FEMALE





MALE JIC (37° FLARE) - MALE JIC (37° FLARE)

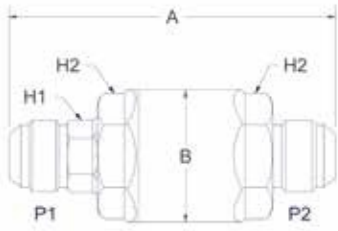

PART NU.	A	B	P1	P2	H1	H2	SEAL KIT
SZ-J06M-J06M	2.94"	1.23"	9/16" - 18 UNF	9/16" - 18 UNF	1/2"	1"	SZ-06-001SK-A
SZ-J08M-J08M	3.88"	1.47"	3/4" - 16 UNF	3/4" - 16 UNF	11/16"	1 1/4"	SZ-08-001SK-A
SZ-J12M-J12M	4.94"	1.97"	1 1/16"- 12 UN	1 1/16"- 12 UN	15/16"	1 5/8"	SZ-12-001SK-A
SZ-J16M-J16M	5.56"	2.22"	1 5/16"- 12 UN	1 5/16"- 12 UN	1 3/16"	1 7/8"	SZ-16-001SK-A
SZ-J20M-J20M	6.06"	2.72"	1 5/8"- 12 UN	1 5/8"- 12 UN	1 1/2"	2 3/8"	SZ-20-001SK-A
SZ-J24M-J24M	6.44"	2.97"	1 7/8"- 12 UN	1 7/8"- 12 UN	1 3/4"	2 1/2"	SZ-24-001SK-A

MALE JIC (37° FLARE) - COMBO - FEMALE JIC (37° FLARE) /  
FEMALE O-RING BOSS (ORB) / SAE J1926-3

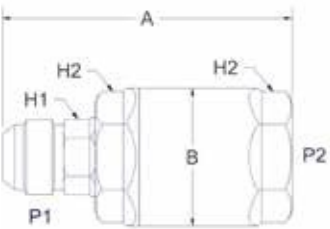

PART NU.	A	B	P1	P2	H1	H2	SEAL KIT
SZ-J06M-JB06F	2.59"	1.23"	9/16 - 18 UNF	9/16 - 18 UNF	1/2"	1"	SZ-06-001SK-A
SZ-J08M-JB08F	3.31"	1.47"	3/4" - 16 UNF	3/4" - 16 UNF	11/16"	1 1/4"	SZ-08-001SK-A
SZ-J10M-JB10F	3.45"	1.73"	7/8" - 14 UNF	7/8" - 14 UNF	13/16"	1 1/2"	SZ-10-001SK-A
SZ-J12M-JB12F	4.12"	1.97"	1 1/16"- 12 UN	1 1/16"- 12 UN	15/16"	1 5/8"	SZ-12-001SK-A
SZ-J16M-JB16F	4.63"	2.22"	1 5/16"- 12 UN	1 5/16"- 12 UN	1 3/16"	1 7/8"	SZ-16-001SK-A
SZ-J20M-JB20F	5.12"	2.72"	1 5/8"- 12 UN	1 5/8"- 12 UN	1 1/2"	2 3/8"	SZ-20-001SK-A
SZ-J24M-JB24F	5.34"	2.97"	1 7/8"- 12 UN	1 7/8"- 12 UN	1 3/4"	2 1/2"	SZ-24-001SK-A
SZ-J32M-JB32F	6.50"	3.88"	2 1/2"- 12 UN	2 1/2"- 12 UN	2 5/16"	3 1/4"	SZ-32-001SK-A



### MALE JIC (37° FLARE) - FEMALE PIPE (NPT)

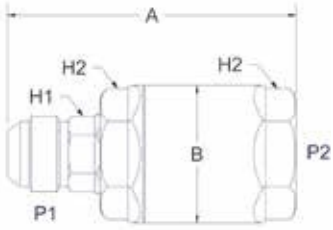

PART NU.	A	B	P1	P2	H1	H2	SEAL KIT
SZ-J08M-F08F	3.31"	1.50"	3/4" - 16 UNF	1/2" NPT	11/16"	1 1/4"	SZ-08-001SK-A
SZ-J12M-F12F	4.19"	2.00"	1 1/16"- 12 UN	3/4" NPT	15/16"	1 5/8"	SZ-12-001SK-A
SZ-J16M-F16F	4.88"	2.22"	1 5/16"- 12 UN	1" NPT	1 3/16"	1 7/8"	SZ-16-001SK-A
SZ-J20M-F20F	5.37"	2.75"	1 5/8"- 12 UN	1 1/4" NPT	1 1/2"	2 3/8"	SZ-20-001SK-A

### MALE JIC (37° FLARE) - FEMALE BSPP

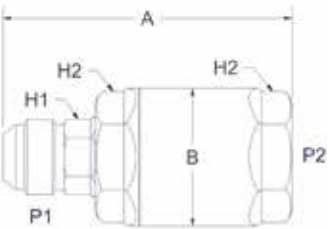

PART NU.	A	B	P1	P2	H1	H2	SEAL KIT
SZ-J12M-P12F	4.19"	1.97"	1 1/16"- 12 UN	G 3/4	15/16"	1 5/8"	SZ-12-001SK-A
SZ-J16M-P16F	4.88"	2.72"	1 5/16"- 12 UN	G 1	1 3/16"	1 7/8"	SZ-16-001SK-A

### MALE JIC (37° FLARE) - MALE BSPP

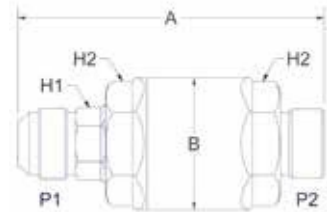

PART NU.	A	B	P1	P2	H1	H2	SEAL KIT
SZ-J12M-P12M	4.19"	1.97"	1 1/16"- 12 UN	G 3/4	15/16"	1 5/8"	SZ-12-001SK-A
SZ-J16M-P16M	4.88"	2.22"	1 5/16"- 12 UN	G 1	1 3/16"	1 7/8"	SZ-16-001SK-A



### MALE PIPE (NPT) - FEMALE PIPE (NPT)

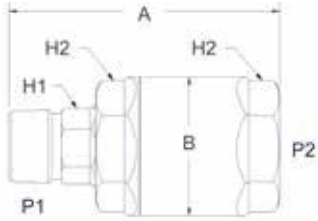

PART NU.	A	B	P1	P2	H1	H2	SEAL KIT
SZ-F08M-F08F	3.00"	1.53"	1/2" NPT	1/2" NPTF	3/4"	1 5/16"	SZ-08-002SK-A
SZ-F12M-F12F	3.88"	1.97"	3/4" NPT	3/4" NPTF	15/16"	1 5/8"	SZ-12-001SK-A
SZ-F16M-F16F	4.12"	2.22"	1" NPT	1" NPTF	1 3/16"	1 7/8"	SZ-16-001SK-A
SZ-F20M-F20F	4.88"	2.72"	1 1/4" NPT	1 1/4" NPTF	1 1/2"	2 3/8"	SZ-20-001SK-A

### MALE PIPE (NPT) - COMBO FEMALE JIC (37° FLARE) / FEMALE O-RING BOSS (ORB) / SAE J1926-3

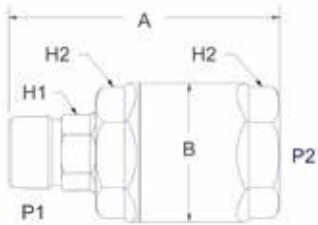

PART NU.	A	B	P1	P2	H1	H2	SEAL KIT
SZ-F12M-JB12F	3.88"	1.97"	3/4 NPT	1 1/16"- 12 UN	15/16"	1 5/8"	SZ-12-001SK-A
SZ-F16M-JB16F	4.12"	2.22"	1 NPT	1 5/16"- 12 UN	1 3/16"	1 7/8"	SZ-16-001SK-A
SZ-F20M-JB20F	4.88"	2.72"	1 1/4 NPT	1 5/8"- 12 UN	1 1/2"	2 3/8"	SZ-20-001SK-A

### MALE BSPP - MALE BSPP

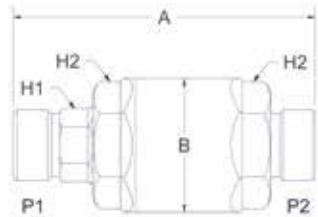

PART NU.	A	B	P1	P2	H1	H2	SEAL KIT
SZ-P08M-P08M	3.44"	1.53"	G 1/2	G 1/2	3/4"	1 5/16"	SZ-08-002SK-A
SZ-P12M-P12M	4.52"	1.97"	G 3/4	G 3/4	15/16"	1 5/8"	SZ-12-001SK-A
SZ-P16M-P16M	5.06"	2.22"	G 1	G 1	1 3/16"	1 7/8"	SZ-16-001SK-A



MALE BSPP - FEMALE BSPP

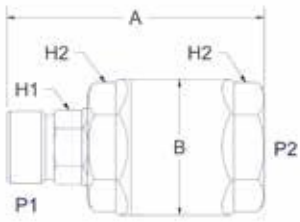

PART NU.	A	B	P1	P2	H1	H2	SEAL KIT
SZ-P08M-P08F	2.94"	1.53"	G 1/2	G 1/2	3/4"	1 5/16"	SZ-08-002SK-A
SZ-P12M-P12F	3.81"	1.97"	G 3/4	G 3/4	15/16"	1 5/8"	SZ-12-001SK-A
SZ-P16M-P16F	4.31"	2.22"	G 1	G 1	1 3/16"	1 7/8"	SZ-16-001SK-A
SZ-P20M-P20F	4.50"	2.72"	G 1 1/4	G 1 1/4	1 1/2"	2 3/8"	SZ-20-001SK-A

MALE ORFS (O-RING FACE SEAL) - MALE ORFS (O-RING FACE SEAL)

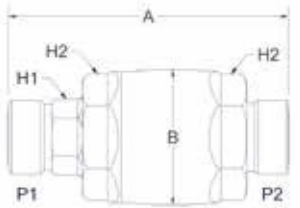

PART NU.	A	B	P1	P2	H1	H2	SEAL KIT
SZ-S06M-S06M	2.77"	1.35"	11/16"-16 UNF	11/16" - 16 UNF	5/8"	1 1/8"	SZ-06-002SK-A
SZ-S08M-S08M	3.50"	1.53"	13/16" - 16 UNF	13/16" - 16 UNF	3/4"	1 5/16"	SZ-08-002SK-A
SZ-S10M-S10M	3.79"	1.86"	1" - 14 UNS	1" - 14 UNS	15/16"	1 5/8"	SZ-10-002SK-A
SZ-S12M-S12M	4.52"	2.09"	1 3/16"- 12 UN	1 3/16"- 12 UN	1 1/16"	1 3/4"	SZ-12-002SK-A
SZ-S16M-S16M	5.12"	2.31"	1 7/16"- 12 UN	1 7/16"- 12 UN	1 5/16"	2"	SZ-16-002SK-A
SZ-S20M-S20M	5.46"	2.72"	1 11/16"- 12 UN	1 11/16"- 12 UN	1 9/16"	2 3/8"	SZ-20-002SK-A

MALE ORFS (O-RING FACE SEAL) - COMBO FEMALE JIC (37° FLARE) / FEMALE O-RING BOSS (ORB) / SAE J1926-3

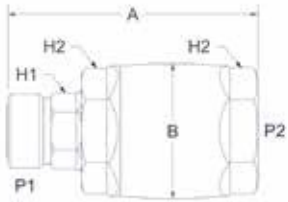

PART NU.	A	B	P1	P2	H1	H2	SEAL KIT
SZ-S12M-JB12F	3.86"	2.09"	1 3/16"- 12 UN	1 1/16" - 12 UN	1 1/16"	1 3/4"	SZ-12-002SK-A
SZ-S16M-JB16F	4.38"	2.31"	1 7/16"- 12 UN	1 5/16" - 12 UN	1 5/16"	2"	SZ-16-002SK-A
SZ-S20M-JB20F	4.68"	2.72"	1 11/16"- 12 UN	1 5/8" - 12 UN	1 9/16"	2 3/8"	SZ-20-002SK-A

MALE ORFS (O-RING FACE SEAL) - FEMALE ORFS (O-RING FACE SEAL)

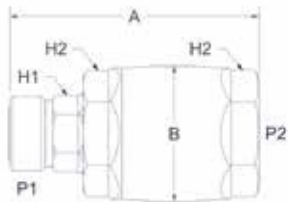

PART NU.	A	B	P1	P2	H1	H2	SEAL KIT
SZ-S08M-S08F	3.00"	1.53"	13/16" - 16 UNF	13/16" - 16 UNF	3/4"	1 5/16"	SZ-08-002SK-A
SZ-S10M-S10F	3.78"	1.85"	1" - 14 UNF	1" - 14 UNF	15/16"	1 5/8"	SZ-10-002SK-A
SZ-S12M-S12F	3.86"	2.09"	1 3/16"- 12 UN	1 3/16"- 12 UN	1 1/16"	1 3/4"	SZ-12-002SK-A
SZ-S16M-S16F	4.38"	2.31"	1 7/16"- 12 UN	1 7/16"- 12 UN	1 5/16"	2"	SZ-16-002SK-A
SZ-S20M-S20F	4.68"	2.72"	1 11/16"- 12 UN	1 11/16"- 12 UN	1 9/16"	2 3/8"	SZ-20-002SK-A
SZ-S24M-S24F	4.92"	3.19"	2.00"- 12 UN	2.00"- 12 UN	1 7/8"	2 3/4"	SZ-24-002SK-A





MALE JIC (37° FLARE) - MALE JIC (37° FLARE) BULKHEAD

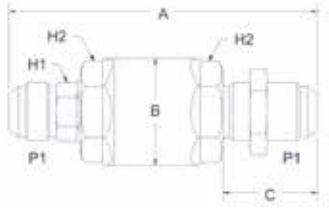

PART NU.	A	B	C	P1	H1	H2	SEAL KIT
SZ-J06M-J06MB	3.71"	1.22"	1.25"	9/16" - 18 UNF	1/2"	1"	SZ-06-001SK-A
SZ-J08M-J08MB	4.63"	1.47"	1.50"	3/4" - 16 UNF	11/16"	1 1/4"	SZ-08-001SK-A
SZ-J12M-J12MB	5.69"	1.97"	1.75"	1 1/16" - 12 UN	15/16"	1 5/8"	SZ-12-001SK-A
SZ-J16M-J16MB	6.31"	2.22"	1.88"	1 5/16" - 12 UN	1 3/16"	1 7/8"	SZ-16-001SK-A
SZ-J20M-J20MB	6.94"	2.72"	2"	1 5/8" - 12 UN	1 1/2"	2 3/8"	SZ-20-001SK-A

MALE ORFS (O-RING FACE SEAL) - MALE ORFS BULKHEAD

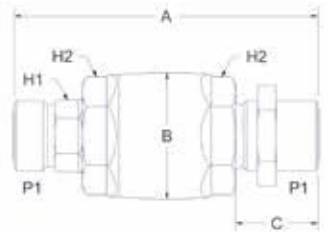

PART NU.	A	B	C	P1	H1	H2	SEAL KIT
SZ-S06M-S06MB	3.62"	1.35"	1.28"	11/16" - 16 UNF	5/8"	1 1/8"	SZ-06-002SK-A
SZ-S08M-S08MB	4.25"	1.53"	1.31"	13/16" - 12 UNF	3/4"	1 5/16"	SZ-08-002SK-A
SZ-S12M-S12MB	5.25"	2.09"	1.41"	1 3/16" - 12 UN	1 1/16"	1 3/4"	SZ-12-002SK-A
SZ-S16M-S16MB	5.88"	2.31"	1.56"	1 7/16" - 12 UN	1 5/16"	2"	SZ-16-002SK-A

MALE METRIC ( DIN 3852 ) - FEMALE BSPP

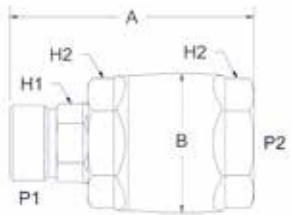

PART NU.	A	B	C	P1	H1	H2	SEAL KIT
SZ-M20SM-P08F	2.95"	1.53"	M20 X 1.5	G 1/2	3/4"	1 5/16"	SZ-08-002SK-A
SZ-M30SM-P12F	3.77"	2.09"	M30 X 2.0	G 3/4	1 1/16"	1 3/4"	SZ-12-002SK-A
SZ-M36SM-P16F	4.27"	2.34"	M36 X 2.0	G 1	1 5/16"	2"	SZ-16-002SK-A
SZ-M42SM-P20F	4.57"	2.72"	M42 X 2.0	G 1 1/4	1 9/16"	2 3/8"	SZ-20-001SK-A



### MALE METRIC ( DIN 3852 ) - FEMALE ORFS ( O-RING FACE SEAL )

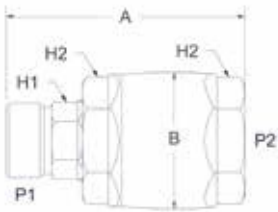

PART NU.	A	B	P1	P2	H1	H2	SEAL KIT
SZ-M30SM-S12F	3.83"	2.31"	M30 X 2.0	1 3/16"- 12 UN	1 1/16"	1 3/4"	SZ-12-002SK-A
SZ-M36SM-S16F	4.33"	2.31"	M36 X 2.0	1 7/16"- 12 UN	1 5/16"	2"	SZ-16-002SK-A
SZ-M42SM-S20F	4.70"	2.72"	M42 X 2.0	1 11/16"- 12 UN	1 9/16"	2 3/8"	SZ-20-001SK-A

### MALE METRIC - MALE METRIC ( DIN 3852 )

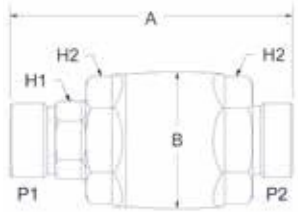

PART NU.	A	B	P1	P2	H1	H2	SEAL KIT
SZ-M24SM-M24SM	3.74"	1.86"	M24 X 1.5	M24 X 1.5	15/16"	1 5/8"	SZ-10-002SK-A
SZ-M30SM-M30SM	4.75"	2.09"	M30 X 2.0	M30 X 2.0	1 1/16"	1 3/4"	SZ-12-002SK-A
SZ-M30SM-M36SM	4.75"	2.09"	M30 X 2.0	M30 X 2.0	1 1/16"	1 3/4"	SZ-12-002SK-A
SZ-M30SM-M42SM	4.75"	2.09"	M30 X 2.0	M30 X 2.0	1 1/16"	1 3/4"	SZ-12-002SK-A
SZ-M36SM-M36SM	5.94"	2.40"	M36 X 2.0	M36 X 2.0	1 5/16"	2"	SZ-16-002SK-A
SZ-M42SM-M42SM	7.08"	2.88"	M42 X 2.0	M42 X 2.0	1 9/16"	2 3/8"	SZ-20-001SK-A

### MALE METRIC - MALE METRIC BULKHEAD ( DIN 3852 )

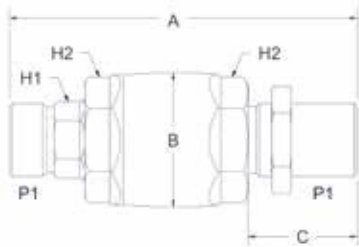

PART NU.	A	B	C	P1	H1	H2	SEAL KIT
SZ-M30SM-M30SMB	5.39"	2.09"	1.57	M30 X 2.0	1 1/16"	1 3/4"	SZ-12-002SK-A
SZ-M36SM-M36SMB	5.94"	2.40"	1.61	M36 X 2.0	1 5/16"	2"	SZ-16-002SK-A
SZ-M42SM-M42SMB	7.08"	2.88"	2.52	M42 X 2.0	1 9/16"	2 3/8"	SZ-20-001SK-A





# 6. 90° SWIVELS STANDARD SERIES

Meet the wide range of 90° Swivel- standard series, designed with the highest standard of durability. Taimi's unique ball-less technology brings reliability to your hydraulic system increasing service life and cutting out leakages. This means higher productivity and lower operating costs.

## WHY CHOOSE TAIMI 90° SWIVELS - STANDARD SERIES?

- **Patented ball-less design**
- **No snap ring, will not dismantle**
- **Triple Seal Protection™**
- **Pressure Spikes Protection™**
- **Easy and quick to repack**
- **Great side loads resistance**
- **A product that pays back: less leaking and better wear resistance**



**Hidrotema**



# WORLDWIDE DISTRIBUTION

Part numbers in orange  
are usually in stock.

Other products are  
manufactured to order

## HOW TO ORDER

SZ90	J	12	M	B	12	F
90° SWIVEL DESIGNATOR	HOSE CONNECTION TYPE J = JIC (37°) FLARE F = NPT P = BSPP S = ORFS (O-RING FACE SEAL) M = METRIC	HOSE SIZE	SHANK CONFIGURATION  M = MALE	HOUSING HOSE CONNECTION TYPE  J = JIC (37°)FLARE B = SAE (O-RING BOSS) F = NPT P = BSPP S = ORFS (O-RING FACE SEAL) M = METRIC	SHANK SIZE  1/16 of an inch	HOUSING CONFIGURATION  M = MALE F = FEMALE



MALE PIPE ( NPT ) - FEMALE PIPE ( NPT )

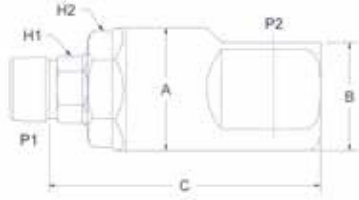

PART NU.	A	B	C	P1	P2	H1	H2	SEAL KIT
SZ90-F06M-F06F	1.35"	1.21"	2.62"	3/8" NPT	3/8" NPT	0.63"	1.12"	SZ-06-002SK-A
SZ90-F08M-F08F	1.53"	1.33"	3.31"	1/2" NPT	1/2" NPT	0.75"	1.31"	SZ-08-002SK-A
SZ90-F12M-F12F	1.97"	1.74"	4.34"	3/4" NPT	3/4" NPT	0.94"	1.63"	SZ-12-001SK-A
SZ90-F16M-F16F	2.22"	1.92"	4.88"	1" NPT	1" NPT	1.19"	1.88"	SZ-16-001SK-A

MALE PIPE ( NPT ) -  
FEMALE O-RING BOSS ( ORB ) / SAE J1926-3

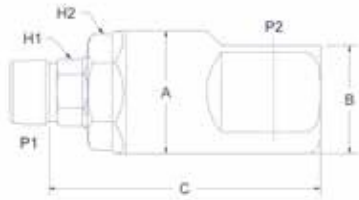

PART NU.	A	B	C	P1	P2	H1	H2	SEAL KIT
SZ90-F08M-B08F	1.53"	1.33"	3.31"	1/2" NPT	SAE 08	0.75"	1.31"	SZ-08-002SK-A
SZ90-F12M-B12F	1.97"	1.74"	4.34"	3/4" NPT	SAE 12	0.94"	1.63"	SZ-12-001SK-A
SZ90-F16M-B16F	2.22"	1.92"	4.88"	1" NPT	SAE 16	1.19"	1.88"	SZ-16-001SK-A
SZ90-F20M-B20F	2.72"	2.37"	5.84"	1 1/4" NPT	SAE 20	1.50"	2.38"	SZ-20-001SK-A

MALE PIPE ( NPT ) - MALE PIPE ( NPT )

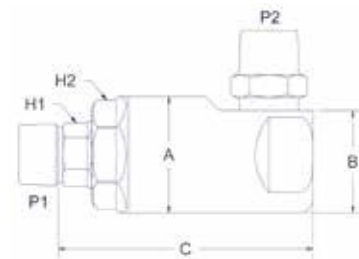

PART NU.	A	B	C	P1	P2	H1	H2	SEAL KIT
SZ90-F08M-F08M	1.53"	2.14"	3.31"	1/2" NPT	1/2" NPT	0.75"	1.31"	SZ-08-002SK-A
SZ90-F12M-F12M	1.97"	2.88"	4.34"	3/4" NPT	3/4" NPT	0.94"	1.63"	SZ-12-001SK-A
SZ90-F16M-F16M	2.22"	3.25"	4.88"	1" NPT	1" NPT	1.19"	1.88"	SZ-16-001SK-A
SZ90-F20M-F20M	2.72"	3.80"	5.84"	1 1/4" NPT	1 1/4" NPT	1.50"	2.38"	SZ-20-001SK-A

MALE PIPE ( NPT ) - MALE JIC ( 37° FLARE )

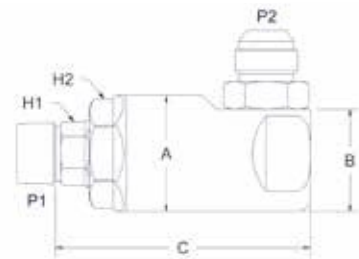

PART NU.	A	B	C	P1	P2	H1	H2	SEAL KIT
SZ90-F08M-J08M	1.53"	2.33"	3.31"	1/2" NPT	3/4" - 16 UNF	0.75"	1.31"	SZ-08-002SK-A
SZ90-F12M-J12M	1.97"	3.07"	4.34"	3/4" NPT	1 1/16" - 12 UN	0.94"	1.63"	SZ-12-001SK-A
SZ90-F16M-J16M	2.22"	3.31"	4.88"	1" NPT	1 5/16" - 12 UN	1.19"	1.88"	SZ-16-001SK-A
SZ90-F20M-J20M	2.72"	3.91"	5.84"	1 1/4" NPT	1 5/8" - 12 UN	1.50"	2.38"	SZ-20-001SK-A



MALE PIPE ( NPT ) -  
MALE ORFS ( O-RING FACE SEAL )

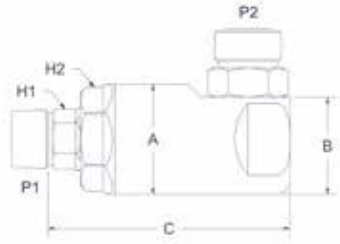

PART NU.	A	B	C	P1	P2	H1	H2	SEAL KIT
SZ90-F08M-S08M	1.53"	2.17"	3.31"	1/2" NPT	13/16" - 16 UNF	0.75"	1.31"	SZ-08-002SK-A
SZ90-F12M-S12M	1.97"	2.93"	4.34"	3/4" NPT	1 3/16" - 12 UN	0.94"	1.63"	SZ-12-001SK-A
SZ90-F16M-S16M	2.22"	3.17"	4.88"	1" NPT	1 7/16" - 12 UN	1.19"	1.88"	SZ-16-001SK-A
SZ90-F20M-S20M	2.72"	3.70"	5.84"	1 1/4" NPT	1 11/16" - 12 UN	1.50"	2.38"	SZ-20-001SK-A

MALE JIC ( 37° FLARE ) -  
FEMALE O-RING BOSS ( ORB ) / SAE J1926-3

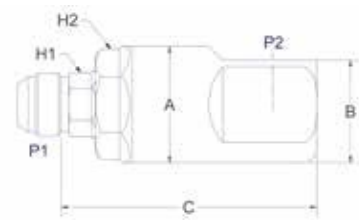

PART NU.	A	B	C	P1	P2	H1	H2	SEAL KIT
SZ90-J06M-B06F	1.22"	1.09"	2.53"	9/16" - 18 UNF	SAE 06	0.50"	1.00"	SZ-06-001SK-A
SZ90-J08M-B08F	1.47"	1.30"	3.28"	3/4" - 16 UNF	SAE 08	0.69"	1.25"	SZ-08-001SK-A
SZ90-J12M-B12F	1.97"	1.74"	4.34"	1 1/16" - 12 UN	SAE 12	0.94"	1.63"	SZ-12-001SK-A
SZ90-J16M-B16F	2.22"	1.92"	4.88"	1 5/16" - 12 UN	SAE 16	1.19"	1.88"	SZ-16-001SK-A
SZ90-J20M-B20F	2.72"	2.37"	5.84"	1 5/8" - 12 UN	SAE 20	1.50"	2.38"	SZ-20-001SK-A

MALE JIC ( 37° FLARE ) - MALE JIC ( 37° FLARE )

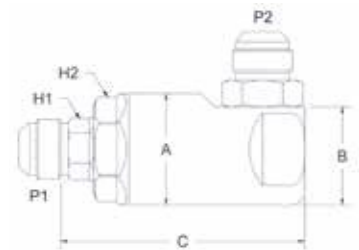

PART NU.	A	B	C	P1	P2	H1	H2	SEAL KIT
SZ90-J06M-J06M	1.22"	1.97"	2.53"	9/16" - 18 UNF	9/16" - 18 UNF	0.50"	1.00"	SZ-06-001SK-A
SZ90-J08M-J08M	1.47"	2.30"	3.28"	3/4" - 16 UNF	3/4" - 16 UNF	0.69"	1.25"	SZ-08-001SK-A
SZ90-J12M-J12M	1.97"	3.07"	4.34"	1 1/16" - 12 UN	1 1/16" - 12 UN	0.94"	1.63"	SZ-12-001SK-A
SZ90-J16M-J16M	2.22"	3.31"	4.88"	1 5/16" - 12 UN	1 5/16" - 12 UN	1.19"	1.88"	SZ-16-001SK-A
SZ90-J20M-J20M	2.72"	3.91"	5.84"	1 5/8" - 12 UN	1 5/8" - 12 UN	1.50"	2.38"	SZ-20-001SK-A

MALE JIC ( 37° FLARE ) - MALE PIPE ( NPT )

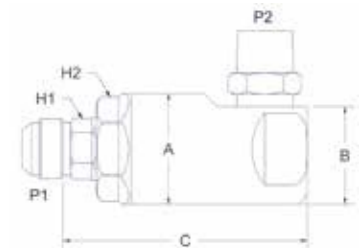

PART NU.	A	B	C	P1	P2	H1	H2	SEAL KIT
SZ90-J06M-F06M	1.22"	1.88"	2.53"	9/16" - 18 UNF	3/8" NPT	0.50"	1.00"	SZ-06-001SK-A
SZ90-J08M-F08M	1.47"	2.11"	3.28"	3/4" - 16 UNF	1/2" NPT	0.69"	1.25"	SZ-08-001SK-A
SZ90-J12M-F12M	1.97"	2.88"	4.34"	1 1/16" - 12 UN	3/4" NPT	0.94"	1.63"	SZ-12-001SK-A
SZ90-J16M-F16M	2.22"	3.25"	4.88"	1 5/16" - 12 UN	1" NPT	1.19"	1.88"	SZ-16-001SK-A
SZ90-J20M-F20M	2.72"	3.80"	5.84"	1 5/8" - 12 UN	1 1/4" NPT	1.50"	2.38"	SZ-20-001SK-A





MALE JIC ( 37° FLARE ) -  
MALE ORFS ( O-RING FACE SEAL )

PART NU.	A	B	C	P1	P2	H1	H2	SEAL KIT
SZ90-J06M-S06M	1.22"	1.88"	2.53"	9/16" - 18 UNF	11/16" - 16 UNF	0.50"	1.00"	SZ-06-001SK-A
SZ90-J08M-S08M	1.47"	2.14"	3.28"	¾" - 16 UNF	13/16" - 16 UNF	0.69"	1.25"	SZ-08-001SK-A
SZ90-J12M-S12M	1.97"	2.93"	4.34"	1 1/16" - 12 UN	1 3/16" - 12 UN	0.94"	1.63"	SZ-12-001SK-A
SZ90-J16M-S16M	2.22"	3.17"	4.88"	1 5/16" - 12 UN	1 7/16" - 12 UN	1.19"	1.88"	SZ-16-001SK-A
SZ90-J20M-S20M	2.72"	3.70"	5.84"	1 5/8" - 12 UN	1 11/16" - 12 UN	1.50"	2.38"	SZ-20-001SK-A

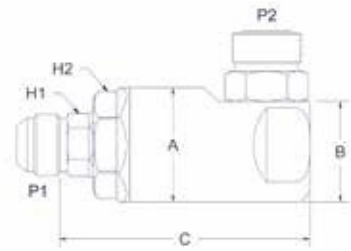

MALE JIC ( 37° FLARE ) - MALE BSPP

PART NU.	A	B	C	P1	P2	H1	H2	SEAL KIT
SZ90-J06M-P06M	1.22"	1.81"	2.53"	9/16" - 18 UNF	G 3/8	0.50"	1.00"	SZ-06-001SK-A
SZ90-J08M-P08M	1.47"	2.09"	3.28"	¾" - 16 UNF	G 1/2	0.69"	1.25"	SZ-08-001SK-A
SZ90-J12M-P12M	1.97"	2.80"	4.34"	1 1/16" - 12 UN	G 3/4	0.94"	1.63"	SZ-12-001SK-A
SZ90-J16M-P16M	2.22"	3.06"	4.88"	1 5/16" - 12 UN	G 1	1.19"	1.88"	SZ-16-001SK-A
SZ90-J20M-P20M	2.72"	3.82"	5.84"	1 5/8" - 12 UN	G 1 1/4	1.50"	2.38"	SZ-20-001SK-A

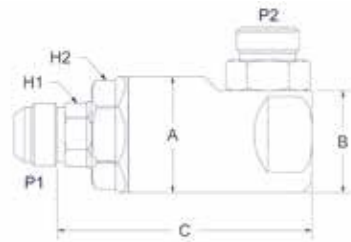

MALE ORFS ( O-RING FACE SEAL ) -  
FEMALE O-RING BOSS ( ORB ) / SAE J1926-3

PART NU.	A	B	C	P1	P2	H1	H2	SEAL KIT
SZ90-S08M-B08F	1.53"	1.33"	3.34"	13/16" - 16 UNF	SAE 08	0.75"	1.31"	SZ-08-002SK-A
SZ90-S12M-B12F	2.09"	1.89"	4.34"	1 3/16" - 12 UN	SAE 12	1.06"	1.75"	SZ-12-002SK-A
SZ90-S16M-B16F	2.34"	2.05"	5.00"	1 7/16" - 12 UN	SAE 16	1.31"	2.00"	SZ-16-002SK-A
SZ90-S20M-B20F	2.88"	2.37"	5.84"	1 11/16" - 12 UN	SAE 20	1.56"	2.38"	SZ-20-002SK-A

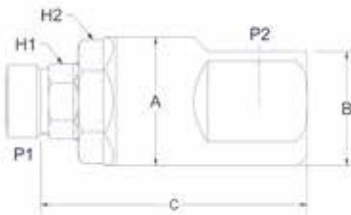

MALE ORFS ( O-RING FACE SEAL ) -  
MALE ORFS ( O-RING FACE SEAL )

PART NU.	A	B	C	P1	P2	H1	H2	SEAL KIT
SZ90-S08M-S08M	1.53"	2.17"	3.34"	13/16" - 16 UNF	13/16" - 16 UNF	0.75"	1.31"	SZ-08-002SK-A
SZ90-S12M-S12M	2.09"	3.09"	4.34"	1 3/16" - 12 UN	1 3/16" - 12 UN	1.06"	1.75"	SZ-12-002SK-A
SZ90-S16M-S16M	2.34"	3.30"	5.00"	1 7/16" - 12 UN	1 7/16" - 12 UN	1.31"	2.00"	SZ-16-002SK-A
SZ90-S20M-S20M	2.88"	3.70"	5.84"	1 11/16" - 12 UN	1 11/16" - 12 UN	1.56"	2.38"	SZ-20-002SK-A

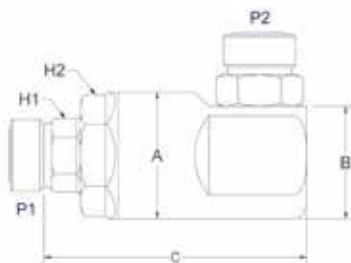

**MALE ORFS (O-RING FACE SEAL) -  
MALE JIC ( 37° FLARE )**

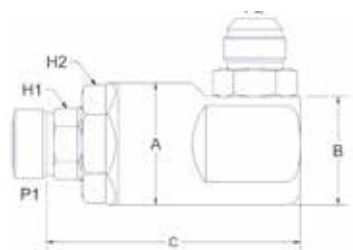

PART NU.	A	B	C	P1	P2	H1	H2	SEAL KIT
SZ90-S08M-J08M	1.53"	2.17"	3.34"	13/16" - 16 UNF	3/4" - 16 -UNF	0.75"	1.31"	SZ-08-002SK-A
SZ90-S12M-J12M	2.09"	3.22"	4.34"	1 3/16" - 12 UN	1 1/16" - 12 UN	1.06"	1.75"	SZ-12-002SK-A
SZ90-S16M-J16M	2.34"	3.44"	5.00"	1 7/16" - 12 UN	1 5/16" - 12 UN	1.31"	2.00"	SZ-16-002SK-A
SZ90-S20M-J20M	2.88"	3.91"	5.84"	1 11/16"-12 UN	1 5/8" - 12 UN	1.56"	2.38"	SZ-20-002SK-A

**MALE ORFS (O-RING FACE SEAL) -  
MALE PIPE (NPT)**

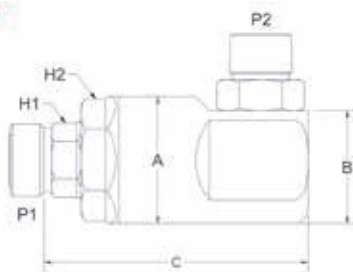

PART NU.	A	B	C	P1	P2	H1	H2	SEAL KIT
SZ90-S08M-F08M	1.53"	2.17"	3.34"	13/16" - 16 UNF	1/2" NPT	0.75"	1.31"	SZ-08-002SK-A
SZ90-S12M-F12M	2.09"	3.02"	4.34"	1 3/16" - 12 UN	3/4" NPT	1.06"	1.75"	SZ-12-002SK-A
SZ90-S16M-F16M	2.34"	3.38"	5.00"	1 7/16" - 12 UN	1" NPT	1.31"	2.00"	SZ-16-002SK-A
SZ90-S20M-F20M	2.88"	3.80"	5.84"	1 11/16"-12 UN	1 1/4" NPT	1.56"	2.38"	SZ-20-002SK-A

**MALE ORFS (O-RING FACE SEAL) - MALE BSPP**

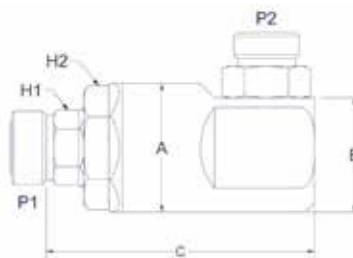

PART NU.	A	B	C	P1	P2	H1	H2	SEAL KIT
SZ90-S08M-P08M	1.53"	2.17"	3.34"	13/16" - 16 UNF	G 1/2	0.75"	1.31"	SZ-08-002SK-A
SZ90-S12M-P12M	2.09"	2.95"	4.34"	1 3/16" - 12 UN	G 3/4	1.06"	1.75"	SZ-12-002SK-A
SZ90-S16M-P16M	2.34"	3.19"	5.00"	1 7/16" - 12 UN	G 1	1.31"	2.00"	SZ-16-002SK-A
SZ90-S20M-P20M	2.88"	3.82"	5.84"	1 11/16"-12 UN	G 1 1/4	1.56"	2.38"	SZ-20-002SK-A

**MALE BSPP -  
FEMALE O-RING BOSS (ORB) / SAE J1926-3**

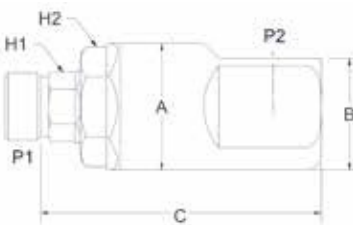

PART NU.	A	B	C	P1	P2	H1	H2	SEAL KIT
SZ90-P08M-B08F	1.53"	1.33"	3.34"	G 1/2	SAE 08	0.75"	1.31"	SZ-08-002SK-A
SZ90-P12M-B12F	1.97"	1.89"	4.34"	G 3/4	SAE 12	0.94"	1.63"	SZ-12-001SK-A
SZ90-P16M-B16F	2.22"	2.05"	5.00"	G 1	SAE 16	1.19"	1.88"	SZ-16-001SK-A
SZ90-P20M-B20F	2.72"	2.37"	5.84"	G 1 1/4	SAE 20	1.50"	2.38"	SZ-20-001SK-A



## MALE BSPP - MALE BSPP

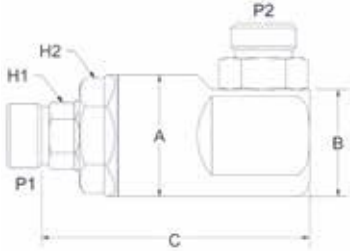

PART NU.	A	B	C	P1	P2	H1	H2	SEAL KIT
SZ90-P08M-P08M	1.53"	2.17"	3.34"	G 1/2	G 1/2	0.75"	1.31"	SZ-08-002SK-A
SZ90-P12M-P12M	1.97"	2.80"	4.34"	G 3/4	G 3/4	0.94"	1.63"	SZ-12-001SK-A
SZ90-P16M-P16M	2.22"	3.06"	4.88"	G 1	G 1	1.19"	1.88"	SZ-16-001SKA
SZ90-P20M-P20M	2.73"	3.82"	5.84"	G 1 1/4	G 1 1/4	1.50"	2.38"	SZ-20-001SK-A

## MALE BSPP - MALE JIC ( 37° FLARE )

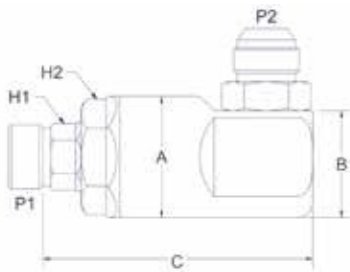

PART NU.	A	B	C	P1	P2	H1	H2	SEAL KIT
SZ90-P08M-J08M	1.53"	2.17"	3.34"	G 1/2	3/4" - 16 UNF	0.75"	1.31"	SZ-08-002SK-A
SZ90-P12M-J12M	1.97"	3.07"	4.34"	G 3/4	1 1/16" - 12 UN	0.94"	1.63"	SZ-12-001SK-A
SZ90-P16M-J16M	2.22"	3.31"	4.88"	G 1	1 5/16" - 12 UN	1.19"	1.88"	SZ-16-001SK-A
SZ90-P20M-J20M	2.73"	3.91"	5.84"	G 1 1/4	1 5/8" - 12 UN	1.50"	2.38"	SZ-20-001SK-A

## MALE BSPP - MALE ORFS (O-RING FACE SEAL)

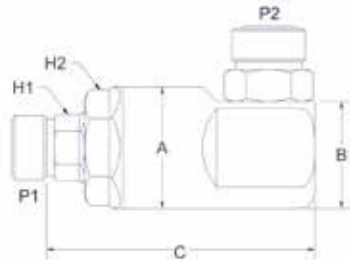

PART NU.	A	B	C	P1	P2	H1	H2	SEAL KIT
SZ90-P08M-S08M	1.53"	2.17"	3.34"	G 1/2	13/16" - 16 UNF	0.75"	1.31"	SZ-08-002SK-A
SZ90-P12M-S12M	1.97"	2.93"	4.34"	G 3/4	1 3/16" - 12 UN	0.94"	1.63"	SZ-12-001SK-A
SZ90-P16M-S16M	2.22"	3.17"	4.88"	G 1	1 7/16" - 12 UN	1.19"	1.88"	SZ-16-001SK-A
SZ90-P20M-S20M	2.72"	3.70"	5.84"	G 1 1/4	1 11/16" - 12 UN	1.50"	2.38"	SZ-20-001SK-A



# 8. DUAL SWIVEL MANIFOLD “A” SERIES



The Dual Swivel Manifold houses two Screw-in Cartridge Swivels. Designed to be bolted or welded together, they are used in multiple applications, 90° or 45° fittings can be installed on both the swivel and static sides of the manifold.

## WHY CHOOSE TAIMI DUAL SWIVEL MANIFOLDS?

- **Pressure Spikes Protection™**
- **Easy and quick to repack**
- **Triple Seal Protection™**
- **Short and sturdy swivel port**
- **Sturdier than bulkhead assemblies**
- **Patented ball-less design**
- **Cannot be pulled apart**
- **High side loads and wear resistance**
- **Custom solutions available**



# ENDLESS POSSIBILITIES



**Part numbers in orange are usually in stock.**

**Other products are manufactured to order.**

## HOW TO ORDER

<b>SM2A</b>	<b>J</b>	<b>12</b>	<b>501</b>
<b>DUAL SWIVEL MANIFOLD DESIGNATOR</b>	<b>HOSE CONNECTION TYPE</b>  J = JIC (37°)FLARE P = BSPP S = ORFS (O-RING FACE SEAL) F = NPT M = METRIC	<b>SHANK SIZE</b>	<b>ASSEMBLY NUMBER</b>





DUAL / MALE JIC (37° FLARE) - MALE JIC (37° FLARE)

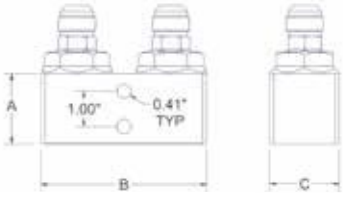

PART NU.	A	B	C	D	P1	P2	SEAL KIT
SM2A-J06-503	1.5"	3.40"	1.5"	3.50"	9/16"- 18 UNF	9/16" - 18 UNF	SZ-06-001SK-A
SM2A-J08-501	1.63"	4.45"	1.63"	3.69"	3/4"- 16 UNF	3/4"- 16 UNF	SZ-08-001SK-A
SM2A-J10-501	1.88"	4.60"	1.88"	4.50"	7/8"- 14 UNF	7/8" - 14 UNF	SZ-10-001SK-A
SM2A-J12-501	2.00"	5.35"	2.00"	4.50"	1 1/16"- 12 UN	1 1/16" - 12 UN	SZ-12-001SK-A
SM2A-J16-501	2.25"	6.31"	2.25"	5.00"	1 5/16"- 12 UN	1 5/16" - 12 UN	SZ-16-001SK-A
SM2A-J1612-501	2.25"	6.31"	2.25"	5.00"	1 5/16"- 12 UN	1 5/16" - 12 UN	SZ-16-001SK-A SZ-12-001SK-A
SM2A-J20-501	2.75"	7.13"	2.75"	6.12"	1 5/8"- 12 UN	1 5/8" - 12 UN	SZ-20-001SK-A

DUAL / MALE JIC (37° FLARE) - MALE ORFS (O-RING FACE SEAL / FLAT FACE O-RING)

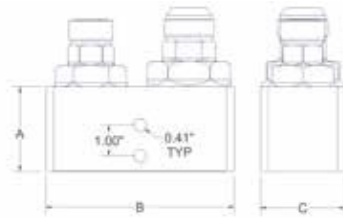

PART NU.	A	B	C	D	P1	P2	SEAL KIT
SM2A-J20S16-501	2.75"	6.84"	2.75"	6.13"	1 5/8"-12 UN 1 7/16"-12 UN	1 5/8"-12 UN 1 7/16"-12 UN	SZ-20-001SK-A SZ-16-002SK-A

DUAL / MALE PIPE (NPT) - MALE PIPE (NPT)

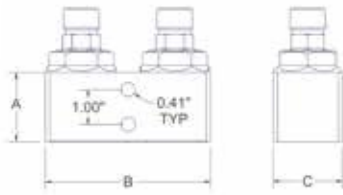

PART NU.	A	B	C	D	P1	P2	SEAL KIT
SM2A-F08-501	1.63"	4.10"	1.63"	3.69"	1/2» NPT	1/2» NPT	SZ-08-002SK-A
SM2A-F12-501	2.00"	5.05"	2.00"	4.50"	3/4" NPT	3/4" NPT	SZ-12-001SK-A
SM2A-F16-501	2.25"	5.59"	2.25"	5.00"	1" NPT	1" NPT	SZ-16-001SK-A

DUAL / MALE BSPP - MALE BSPP

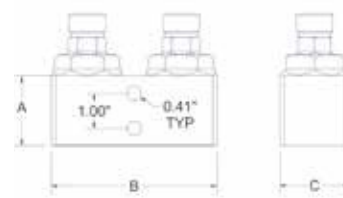

PART NU.	A	B	C	D	P1	P2	SEAL KIT
SM2A-P12-501	2.00"	5.14"	2.00"	4.50"	G 3/4	G 3/4	SZ-12-001SK-A
SM2A-P16-501	2.25"	5.86"	2.25"	5.00"	G 1	G 1	SZ-16-001SK-A



# 9. TAIMI RINGS

A simple, light and sturdy solution to support and route hoses while still allowing the complete relief of torsion during operations. They are a perfect complement to our swivel solutions for a reliable hose routing.



## WHY CHOOSE TAIMI RINGS ?

- Higher performance
- Cost savings on hoses
- Better hose grouping, control and support
- Increased operating time
- Less maintenance
- Reduced oil consumption
- Easy to set up and to access hoses
- Increased flexibility (no rigid hose section)
- Reduced pressure drop in the system
- Sustainable



**Hidrotema**



# HIGHER PERFORMANCE

## HOW TO ORDER

**Part numbers in orange  
are usually in stock.**

**Other products are  
manufactured to order**

SHH	16	524P
TAIMI RINGS DESIGNATOR	HOSE SIZES	ASSEMBLY DESIGNATOR



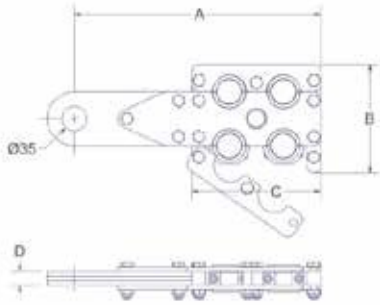

## FORESTRY KITS

PART NU.	A	B	C	D	HOSES SIZE
SHH-16-524P	345,5	152,4	180,3	19,1	4x 16, 1x 04
SHH-16-524K	345,5	152,4	180,3	19,1	4x 16, 1x 04

\*Dimensions are in mm

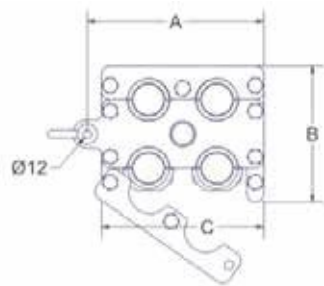

PART NU.	A	B	C	D	HOSES SIZE
SHH-16-524SPC	196,2	152,4	180,3	19,1	4x 16, 1x 04
SHH-1608-526W	345,5	152,4	248,0	44,5	4x 16, 2x 08, 1x 04

\*Dimensions are in mm

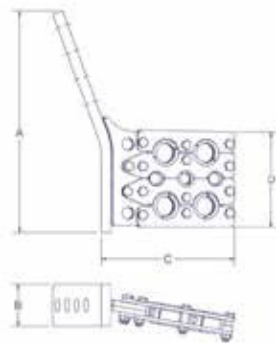

PART NU.	A	B	C	D	HOSES SIZE
SHH-1608-526SPC	271,7	152,4	248,0	19,1	4x 16, 2x 08, 1x 04
SHH-1684-527L	407,0	172,5	244,8	76,2	2x 16, 2x 1612, 1x 08, 2x 04

\*Dimensions are in mm

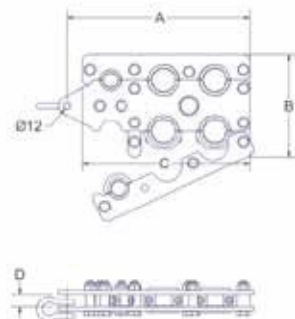

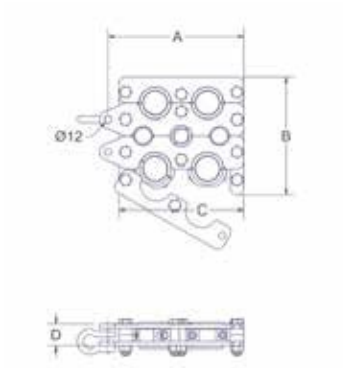

PART NU.	A	B	C	D	HOSES SIZE
SHH-1684-527LPC	196,2	172,5	180,3	76,2	2x 16, 2x 1612, 1x 08, 2x 04

\*Dimensions are in mm

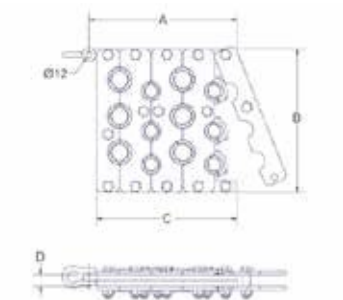

#### UNDERGROUND MINING JUMBOS & BOLTERS KITS

PART NU.	A	B	C	D	HOSES SIZE
SHH-1208-566S	246,2	238,1	233,3	19,1	6x 12, 6x 08
SHH-161208-515S	246,2	247,6	239,7	19,1	1x 16, 2x 12, 12x 08

\*Dimensions are in mm

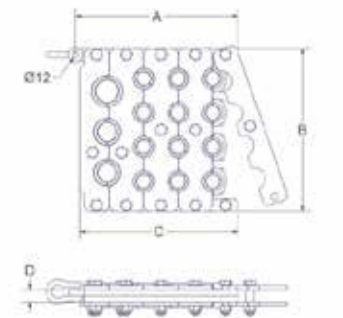





## 10. STRAP-WRAP

Strap-Wrap™ was developed and patented by Taimi to group and support hoses. Made out of flexible webbing, Strap-Wrap™ works well on long hose groups, taking the load off press fittings and on short hose groups, keeping plastic wrap from sliding down.

### WHY CHOOSE TAIMI STRAP-WRAP?

- Groups and protects hoses against stretching and tearing
- Can be solidly attached to both ends and will not shift during operation
- The double Strap-Wrap allows for the hose groups to be secured on several points along the line for the best possible routing
- Resistant material, no sensitivity to temperature variations
- Excellent visibility
- Can group as many hoses as needed
- Flexible and easy to install



**Hidrotema**



# SUSTAINABLE SOLUTIONS

STRAP-WRAP<sup>®</sup> PATENTED



## HOW TO ORDER

<b>SW2</b>	<b>25</b>	<b>001</b>
<b>STRAP-WRAP - DESIGNATOR</b>	<b>WIDTH (1/10 INCH)</b>	
<b>SW1 = SINGLE STRAP SW2 = DOUBLE STRAP</b>	<b>AVAILABLE IN 2.5 INCH WIDTH or 50 mm</b>	



Taimi's Strap-Wrap™ product is the combination of the single and the double straps. The double strap is used as the main support strap, while the single strap is woven into the double strap and around the hose group. It is easy to manipulate at any temperature. It is light and takes little space for shipping and storage. It gives great accessibility to the hoses, thus reducing the time required to inspect and replace them.

### Setting up

The Strap-Wrap system contains three (3) items. The double (main support) strap, the attachment buckle, and the single strap that wraps around the hose group.

- 1- Measure the interior length of the hose group's curve to find the required length of double strap.**
- 2- Cut the double strap to the desire length and fasten attachment buckles to an end.**

You can melt the ends (just like with a nylon rope) to prevent the strap from unweaving. The distance between the buckles and the attachment points can vary depending on the application. You can secure the buckles on the equipment, using a piece of chain.

**SINGLE STRAP**

**DOUBLE STRAP**

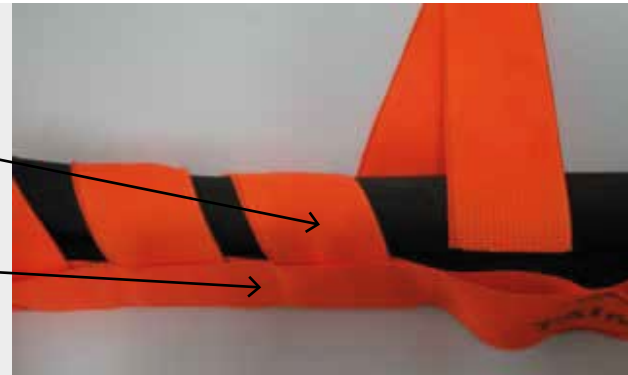

Note : Taimi supplies buckles to fit most types of equipment, usually using a piece of chain.

You can also use different ways to secure your set up.

- 3-Weave the single strap around the hose group and into the double strap. Near the buckle, double the single strap in the last loop before securing the single strap to the buckle. Once it is attached to one end, tighten your way back to the other end before fastening it, making a nice tight bundle.**



Once in place you do not have to remove it to access hoses; just release the ends and the first loop if needed to make the whole thing loose. This way, you can pull out a hose and replace it.

**Taimi's double Strap-Wrap™ will also effectively keep plastic wraps from sliding down a hose group. Simply weave your spiral wrap into a short length of Taimi's Strap-Wrap™ and secure it to your machine.**





# 11. CUSTOM PRODUCTS



Custom products are designed for specific applications and machines.

## WHY CHOOSE TAIMI CUSTOM PRODUCTS ?

Cost savings up to 75% including :

- Hydraulic hoses
- Press fittings
- Live swivels
- Hydraulic oil
- Manpower
- Downtimes
- 
- 

**Part numbers in orange are usually in stock.**

**Other products are manufactured to order**



**Hidrotema**



# 11.1 SWIROLLS FOR LOGMAX HARVESTER HEADS



LENGTH : 13.25" - WIDTH : 9.66" - HEIGHT : 7.63"

WEIGHT : 51.5 LBS - SEAL KIT : SZ-SRL-301SK

U-BOLT LOCKING DEVICE : SRF-85-113

## JIC CONFIGURATIONS

PART NU.	PORTS
SR4S-JJ-502	3 X J16, 1 X J12
SR4S-JJ-504	3 X J16, 1 X J08
SR4S-JJ-505	2 X J16, 2 X J12
SR4S-JJ-506	2 X J16, 1 X J12, 1 X J08
SR4S-JJ-520	2 X J20, 2 X J12
SR5-JJ-503	3 X J16, 2 X J12

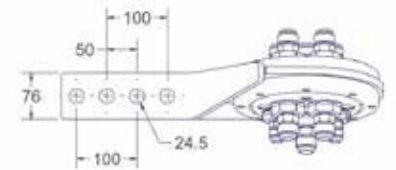
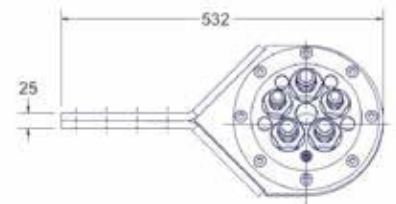

## BSPB CONFIGURATIONS

PART NU.	PORTS
SR4S-PP-504	3 X P16, 1 X P08
SR4S-PP-505	2 X P16, 2 X P12
SR4S-PP-506	2 X P16, 1 X P12, 1 X P08
SR5-PP-506K	2 X P16, 2 X P12, 1 X P08
SR5-PP-507	2 X P16, 1 X P12, 2 X P08

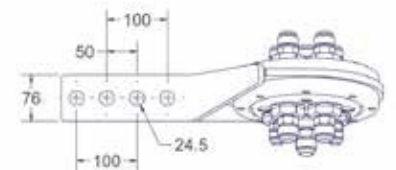
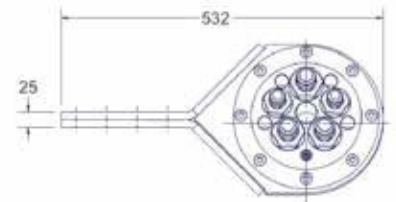

## ORFS CONFIGURATION

PART NU.	PORTS
SR5-SS-506	1x S08, 1 x S12, 2 x S16





## 11.2 SWIROLLS FOR SOUTHSTAR HARVESTER HEADS

LENGTH : 13.25" - WIDTH : 9.66" - HEIGHT : 7.63"  
 WEIGHT : 62.2 LBS - SEAL KIT : SZSRS-302SK  
 U-BOLT LOCKING DEVICE : SRF-85-113

### JIC CONFIGURATIONS

PART NU.	PORTS
SR4S-JS-503	2 X JIC 16, 2 X JIC 12

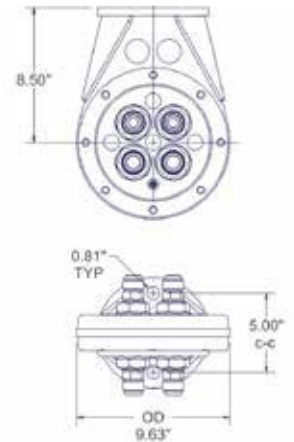

## 11.3 BLOCK FOR CATERPILLAR TRACK HARVESTERS BOOM

PART NU.	REFERENCE	A	B	C	PORTS	WEIGHT
SM4C-S201208-502	501HD Main Boom & 501HD Stick Boom	12.5"	2.20"	7.5"	3 X ORFS 20 3 X ORFS 12 3 X ORFS 08	52 Lbs
SM5F-J1208-504	Full Kit For CAT 501HD Boom	12.5"	2.20"	7.5"	2 X 3 X ORFS 20 3 X ORFS 12 3 X ORFS 08	104 Lbs

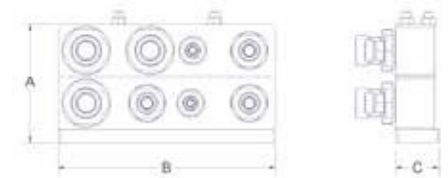

# 12. SEAL KIT REPLACEMENT

1. **Read the safety precautions in section 1 of the product catalog before going any further!**
2. **Relieve pressure before dismanteling hydraulic lines**
3. **Clean work space**
4. **Remove nut**  
Pneumatic torque tool and vise recommended
5. **Remove seal kit** - Remove debris & clean grooves
6. **Install new seal kit**
7. **Assemble cartridge**
8. **Tighten**

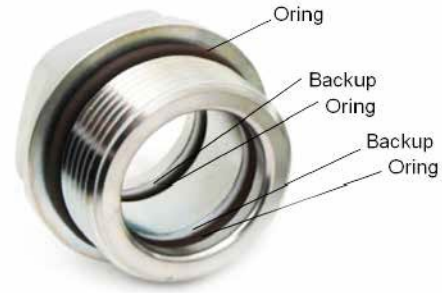

## CARTRIDGE SWIVEL ASSEMBLY TORQUE

SIZES	FT-LBS	NM
06	125	170 Nm
08	215	290 Nm
10	300	405 Nm
12	390	530 Nm
16	490	665 Nm
20	800	1080 Nm
24	900	1215 Nm
32	1000	1350 Nm

### Respect recommended torque

- Over-tightening may result in swivel failure
- Under-tightening may result in swivel dismantling

- Dry torque - Lubricate external o-ring



Swivel failure during operation can cause fluid to escape. Escaping fluid under pressure can penetrate skin causing serious injury or death. Always wear safety equipment before approaching hydraulic equipment under pressure

# 13. WARRANTY & LIMITATION OF LIABILITY

**Every swivel product we carefully manufacture is reliable and leak resistant like no other you have ever used. Sure, there are important fine prints to our warranty which we invite you to read. But despite all the legal stuff below, please contact us if you experience an issue that you did not expect, at any moment.**

Taimi products used under our specifications are guaranteed against defects in materials and workmanship for a period of 12 months or 2000 hours of use. Taimi's obligation under this warranty is limited to the repair or exchange of the defective product, at Taimi's option. This is the sole remedy for breach of warranty. Taimi will in no event be liable to anyone for lost profit, special, indirect, incidental, consequential or exemplary damages, whether based upon negligence, breach of warranty, strict liability or otherwise, nor for any sum in excess of the price received for the products for which liability is claimed.



This warranty is void if the defect is caused by improper installation, use or maintenance of the products. Products that have been modified are not covered under this warranty. Normal wear and tear, maintenance, seal kits and freight are not covered by this warranty. Any description of the products is for the sole purpose of identifying such products and shall not create an express warranty that the goods shall conform to such description. Buyer is solely responsible for determining the suitability of products sold hereunder for use by buyer. Taimi products should not be used as structural or load bearing components.

Some states do not allow the exclusion or limitation of incidental or consequential damages, and some states do not allow limitations on how long an implied warranty lasts, so the above limitation and exclusion may not apply to you. This warranty gives you specific legal rights, and you may also have other rights which vary from state to state.

All other warranties, express or implied, including, but not limited to warranties of merchantability and fitness for a particular purpose, are expressly disclaimed.





**Hidrotema**

## Product Overview







---

With 70 years of experience in the hydraulic industry, Faster has designed and manufactured over 500 million quick-release couplings and has registered more than 100 patents.

Our product portfolio entails several solutions, grouped into 3 main areas: single couplings, Casting Solutions, and MultiFaster.

Our offer covers several areas of application, including Agriculture, Mobile & Construction Equipment, Industrial & Other Applications.

---

#### ICONS LEGEND



Connection Under Pressure:  
Allowed Male Half up to W.P.



Connection Under Pressure:  
Allowed Both Halves



Connection Under Pressure:  
Allowed Residual



Connection and disconnection  
under residual pressure both halves



Disconnection Under Pressure:  
Allowed Male Half up to W.P.



Connection Under Pressure:  
Not Allowed





---

# Agriculture

---

Agriculture is the leading field of application for quick-release hydraulic couplings. Faster has developed a full range of products, covering all the hydraulic connections on regular tractors, both on rear hydraulic lines and front loaders. Moreover, we have selected products specifically designed for harvesting applications.

- Sleeve Retraction
- Push-Pull
- High Flow
- Power Beyond
- Castings
- Multifaster For Front Loaders
- Multifaster For Harvesting

# Sleeve Retraction



## NV



Male and Female couplings with poppet valve shut-off system.

Available in size; 1/4", 3/8", 1/2", 3/4", 1", 1-1/4", 1-1/2", 2".

### Accessories and spares



TM... / TF...



TM... S/TF... S



TM12-38



Seal kits

## ANV



Standard couplings for agriculture applications.

Available in size; 1/4", 3/8", 1/2", 3/4", 1", 1-1/4", 1-1/2", 2".

### Accessories and spares



Seal kits

## ANV Zinc-Nickel



Standard couplings for agriculture applications with Zn-Ni surface treatment for improved resistance.

ISO 7241 part A interchange.

Available in size; 1/4", 3/8", 3/4", 1".

### Accessories and spares



Seal kits

# Push-Pull



## CPV Zinc-Nickel



Push-pull couplings, designed for panel mounting installation. Zinc-Nickel Surface Treatment for improved resistance. Breakaway function. ISO 7241 part A interchange. Wide range of threads available upon request.

Available in size 1/2".

### Accessories and spares



TM 12 .../TM 12-38 ...



TM 12 S



Seal kits

## 3CPV



Female couplings designed for panel mounting installation and connection to flexible hoses. Connectable with Male under residual pressure. Breakaway function. Available in size 1/2".

### Accessories and spares



TA ...



TM 12 .../TM 12-38 ...



TARV 45



Seal kits

## 6DNPV



Push-Pull Female couplings for rigid mounting connectable with Male and Female under pressure, disconnectable under pressure with low effort. Equipped with one or two oil collecting ports to collect clean oil and reduce spillage. Available in size 1/2".

### Accessories and spares



Seal kits

---

# High Flow Resistant



## 3CFHF



Male and Female Push-Pull couplings for agriculture connectable with Male under residual pressure.  
Maximum flow rate: 250 l/min.  
Breakaway function.



---

### Accessories and spares

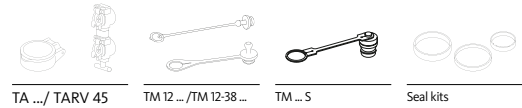

TA .../TARV 45

TM 12 .../TM 12-38 ...

TM ... S

Seal kits

## 4SRHF



Male and Female Push-Pull couplings for agriculture connectable under residual pressure in both Male and Female side.  
Maximum flow rate: 250 l/min.  
Breakaway function.



---

### Accessories and spares

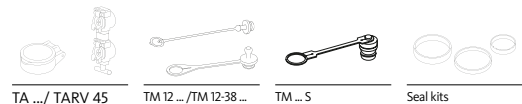

TA .../TARV 45

TM 12 .../TM 12-38 ...

TM ... S

Seal kits

---

# Power Beyond



## 5FPI



Flat Face couplings specifically designed for Power Beyond applications. Interchangeable according to ISO 16028. Connection and disconnection under residual pressure allowed.

Equipped with collecting port for clean oil.

Available in sizes 1/2" and 3/4".

Flow rate up to 150 l/min, depending on the size.



---

### Accessories and spares

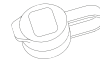

TM 5FPI ...

## FPI



Flat Face couplings specifically designed for Power Beyond applications. Interchangeable according to ISO 16028. Breakaway function.

Connection under pressure allowed.

Available in sizes 1/4", 3/8", 1/2", 3/4", 1".

Flow rate up to 210 l/min, depending on the size.



---

### Accessories and spares



TM FPI ...



---

# Casting Solutions



---

## Manifold with screwed couplings for Rear SCV



Cast iron manifold with 1/2" couplings screwed on. Designed to be screwed directly on control blocks. Every single casting is specifically developed for each tractor manufacturer, to meet impending space requirements. Each Faster manifold block is specifically designed to match a specific control block interface. Each manifold can be equipped with different Female couplings for agriculture, depending on the required features. It can also be upgraded with compatible couplings of different series.

---

## Block with semi-integrated cartridges for Rear SCV



Cast iron blocks equipped with two semi-integrated cartridges, available both poppet valve ISO 7241 part A and flat face ISO 16028. Available size: 1/2" and 3/4".

The same block is suitable for both ISO A and Flat Face cartridges, easy interchangeable to ensure flexibility. Push-pull connection. Great ease to connect and disconnect agricultural implements thanks to relief of internal residual pressure ensured by one dedicate lever for each line. Breakaway feature. Replacement of the lever does not require disassembling of the block.

---

## Block with integrated cartridges for Rear SCV



Cast iron block with fully integrated cartridges, connection assisted by lever.

Possible to fit either poppet or flat face cartridges in 3 different sizes: 1/2", 5/8" or 3/4".

Connection and disconnection under pressure allowed.

---

# MultiFaster for Front Loaders



## PC206



MultiFaster compact. It allows connection with mobile plate or stand-alone counterpart couplings, 2 lines 3/8".

The disconnection of stand-alone counterpart couplings is made by dedicated push buttons. This feature can be extended to all MultiFaster range.

---

### Accessories and spares



KIT3FN



Seal kits

## P508



Multifaster 4 lines, size O8.

*A brand new feature added to our MultiFaster: the automatic dust cover. A new addition applied to ease and facilitate the connection, giving the user the possibility to automatically open the dust cover, adding more comfort to the manouvre. This system is patented and soon a kit with this solution will be available.*

---

### Accessories and spares



KIT2FN



KIT3FN



Seal kits

## PSA06



MultiFaster 4 lines 3/8".

Working pressure 25 Mpa.

Flow rate @ 0.2 MPa: 40 l/min.

---

### Accessories and spares



KIT2FN

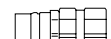

KIT3FN



Seal kits

---

# MultiFaster for Harvesting



## PLK



MultiFaster 5 lines. 2 lines size O6, 3 lines size O9, 1 housing for electrical connector.  
Working pressure 25 Mpa.  
Flow rate @ 0.2 MPa: 2 lines 20 l/min, 3 lines 35 l/min.

---

### Accessories and spares



KIT2FN



KIT3FN



Seal kits

## P5065



MultiFaster 5 lines. 3 lines O4, 2 lines O6.  
Working pressure 25 Mpa.  
Flow rate @ 0.2 MPa: 3 lines 20 l/min, 2 lines 40 l/min.

---

### Accessories and spares



KIT2FN



KIT3FN



Seal kits

## Automatic Connection



MultiFaster suitable for Harvesting, with automatic alignment system. Fixed plate designed to self-align with mobile plate to complete connection. This kind of product allows the operator to complete the connection with safety, comfort and time saving. This MultiFaster can be customized with addition of electrical connectors.

---

# Mobile & Construction Equipment

---

Construction Equipment is a challenging field of application for quick-release hydraulic couplings, where couplings must perform in tough environmental conditions, due to dust, mud, vibrations, temperature and pressure peaks. Faster has developed several solutions for the CE market, including Flat Face couplings, to avoid any leakage, Screw to Connect couplings, robust and reliable, and Casting solutions, to ensure the connection of multiple lines with decompression feature.

- Flat Face
- Screw To Connect
- Castings Solutions
- Multifaster

# Flat Face



## FFH



Flat Face Male and Female couplings.  
The flat valve shut-off system prevents contamination and spillage.  
Real maximum working pressure of 35 MPa and Zinc-Nickel plating. Available sizes: 1/8", 1/4", 3/8", 1/2", 5/8", 3/4", 1".  
Interchangeable according to ISO 16028.  
Size 1/8" has surface treatment in Mate 500 (CrIII) and it is not ISO interchangeable.

### Accessories and spares



TAF ...



TMF 38 .../TFF 38 ...



TM 2FI .../TF 2FI ...



TM2FI...S/TMFFH...S  
TF2FLS/TFFFH...S

## 3FFH



Flat Face Male and Female couplings.  
The flat valve shut-off system prevents contamination and spillage.  
Real maximum working pressure of 35 MPa and Zinc-Nickel plating.  
Connectable under residual pressure. It is possible to couple either a 3FFH Female half under pressure with a FFH Male half, or a 3FFH Male half under pressure with a FFH Female half.  
Available sizes: 3/8", 1/2", 5/8", 3/4".  
Interchangeable according to ISO 16028.

### Accessories and spares



TAF ...



TMF 38 .../TFF 38 ...



TM 2FI .../TF 2FI ...



TM2FI...S/TMFFH...S  
TF2FLS/TFFFH...S

## FSH



Flat Face Female couplings, equipped with sector latching technology.  
The sector latching system enables to effectively tackle the Brinelling effect, provoked by high frequency impulse pressures.  
Real maximum working pressure of 35 MPa and Zinc-Nickel plating.  
Connectable under residual pressure in the Male half when coupled with a 3FFH Male coupling.  
Available sizes: 3/8", 1/2", 3/4", 1".  
Interchangeable according to ISO 16028.

### Accessories and spares



TAF ...



TMF 38 .../TFF 38 ...



TM 2FI ...



TM 2FI ... S

# Screw to Connect



## FHV



Screw-on Flat Face couplings, suitable for construction equipment and heavy duty applications. The Zinc-Nickel plating guarantees a remarkable resistance to corrosion. No hose torsion during connection and disconnection thanks to the internal bearing system. Equipped with a safety sleeve to prevent accidental disconnections due to vibrations. Faster proprietary profile. Part Number with ET have Extended Temperature Range (from -30° to 120 ° C) in connected configuration. Female Part Number with IP are certified Ingress Protection 54. Male Part Number with K are the compact version. Available sizes: 3/8", 1/2", 3/4", 1", 1-1/4", 1-1/2", 2".

### Accessories and spares



TM-TF FHV ...



TM FHV ...S/TF FHV ...S



Seal kits

## FLV



Screw-on Flat Face couplings, with extremely compact and robust design.

Ideal for applications in which a flat face connection is required and there are no significant residual pressures to manage.

Available sizes: 3/8", 1/2", 3/4", 1".

## OGV ST



Screw to connect couplings for Oil & Gas application, market interchange.

Equipped with a marker that confirms the complete connection and a longer locking sleeve for an improved engagement.

Available sizes: 1-1/2", 2".

### Accessories and spares

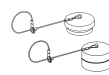

TM OGV ... S/  
TF OGV ... S



---

# Casting Solutions



---

## Auxiliary Lines Block (3 ports)



Castings with cartridges for Construction Equipment. The first cast iron block ever designed to quickly connect and disconnect attachments on skid steers and other light equipment machines. Designed to connect the circuit with residual pressure on both ends. The decompression feature allows to connect the circuit with residual pressure on both ends. 1/2" and 3/4" cartridges can both fit into the 4BD4FH block. Higher flow capability is guaranteed when using 3/4" cartridges. Can be equipped with 4FFH or 4FSH cartridges. Cartridges share all the benefits of the FFH/FSH couplings technology.

---

## Auxiliary Lines Block (3+2 HF ports)



5 Lines block unifies two hydraulic lines of different dimensions in one single casting, giving the option to decompress both lines and collect the drained oil in one single line. The block connects to the machine hydraulic circuit thanks to only two adaptors, and divides the oil flow between the above line and the below line by internal channels properly designed to optimize the flow. This solution offers a great flexibility to the machine in the use of a larger range of attachments and a very easy installation.

The cast iron block shown in the picture is for illustrative purposes only.  
The shape of each block is tailor designed to meet the manufacturer's dimensional requirements.

# MultiFaster



## P4A



MultiFaster 4 lines. 2 lines size 1", 2 lines size 1/2", available with electrical connector in 1/2".  
Workig pressure: 25 MPa.  
Flow rate @ 0.2 MPa: 2 lines 70 l/min, 2 lines 150 l/min.

### Accessories and spares

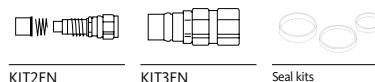

KIT2FN

KIT3FN

Seal kits

## MultiGrease



MultiFaster with special cartridge for central lubrication system and an electrical connector (7 pins) included. 2 lines, size 1/2".  
This feature (special cartridge equipped with shunt system) can be extended to all MultiFaster range.

### Accessories and spares

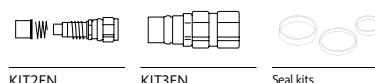

KIT2FN

KIT3FN

Seal kits

## PH510 S



MultiFaster 4 lines for High Pressure applications. 2 lines size O8, 2 lines size 12. Working Pressure: 46 MPa.  
Flow rate @ 0.2 MPa: 2 lines 60 l/min, 2 lines 105 l/min.

### Accessories and spares

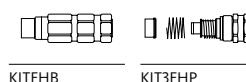

KITFHB

KIT3FHP

---

# Industrial & Other Applications

---

The Industrial applications field is a wide area and it includes several concepts. Products designed for industrial production are used in order to reduce downtime during maintenance operations.

This products are generally characterized by different materials and different levels of performances, to match a broad variety of applications.

- Sleeve Retraction / ISO 7241 - B
- Flat Face / ISO 16028
- Screw to Connect /Faster Interchange
- High Pressure
- Oil & Gas / Snap Tite
- BOP
- Refrigeration
- Check Valves & Diagnostic
- Special Solutions
- Automatic Multiconnections
- MultiFaster for Industrial Applications
- MultiFaster for High Pressure

# Sleeve Retraction / ISO 7241 - B



## HNV



Male and Female couplings for industrial applications with poppet valve shut-off system. Complete range of sizes available with BSP, NPT and SAE Female threads. Interchangeable according to ISO 7241 Part B.

Available sizes: 1/8", 1/4", 3/8", 1/2", 3/4", 1", 1-1/2", 2".

### Accessories and spares



TMH.../TFH



TMH...S/TFH...S



Seal kits

## HNV brass



Male and Female couplings for industrial applications with poppet valve shut-off system. Brass version available with NBR or Viton seals. Interchangeable according to ISO 7241 Part B.

Available sizes: 1/8", 1/4", 3/8", 1/2", 3/4", 1", 1-1/2".

### Accessories and spares



TMH.../TFH



TMH...S/TFH...S



Seal kits

## HNV stainless steel



Male and Female couplings for industrial applications with poppet valve shut-off system. Stainless Steel version (AISI 316) with Viton seals. Interchangeable according to ISO 7241 Part B.

Available sizes: 1/4", 3/8", 1/2", 3/4", 1", 1-1/2", 2".

### Accessories and spares



TMH.../TFH



TMH...S/TFH...S



Seal kits

# Flat Face / ISO 16028



## FFH



Flat Face Male and Female couplings for industrial applications. Steel version (Mate 1000) with seals in NBR. Interchangeable according to ISO 16028. Available sizes: 1/8", 1/4", 3/8", 1/2", 3/4", 1", 1-1/2".

### Accessories and spares



TAF ...



TMF 38 .../TFF 38 ...



TM 2FI .../TF 2FI ...



TM 2FI ...S/TMFFH ...S  
TF 2FL ...S/TFFFH ...S

## 2FFI brass



Flat Face Male and Female couplings for industrial applications. Brass version with seals in Viton. Interchangeable according to ISO 16028. Available in size 1/2".

### Accessories and spares



TM 2FI .../TF 2FI ...



TM 2FI ...S/TF 2FL ...S

## 2FFI stainless steel



Flat Face Male and Female couplings for industrial applications. Stainless Steel version (AISI 316) with Viton seals. Available sizes: 1/4", 3/8", 1/2", 3/4", 1".

### Accessories and spares



TFF 38 ...



TM 2FI .../TF 2FI ...



TM 2FI ...S/TF 2FL ...S

# Screw to Connect /Faster Interchange



## FHV HD



Screw-on flat face couplings, equipped with a double Bearing Ball system and greasing nipple. The Zinc-Nickel plating guarantees a remarkable resistance to corrosion. Connectable by hand up to 35 MPa residual pressure in the male half. No hose torsion during connection and disconnection thanks to the internal bearing system. Equipped with a safety sleeve to prevent accidental disconnections due to vibrations. Available sizes: 1", 1-1/4", 1-1/2".

### Accessories and spares



TM-TF FHV ...

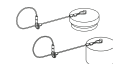

TM FHV ...S/  
TF FHV ...S



Seal kits

## VV



Screw to connect standard couplings, double function sleeve. VV series couplings are very robust and reliable and allow to connect under residual pressure. Thanks to a double function sleeve it's also possible to connect a female part with either VV or NV male halves. Faster proprietary profile. Available sizes: 1/4", 3/8", 1/2", 3/4", 1".

### Accessories and spares



TMV 38 / TFV 38



TMVM ... / TFVM ...



TMV ... SS/  
TFV ... SS



Seal kits

## VVS



Screw to connect couplings for high pressure applications. Couplings commonly used for applications characterized by very high working pressures and peaks. Heavy duty internal components guarantee the maximum safety and reliability. Faster proprietary profile. Interchangeable with Faster VV series. Available sizes: 1/4", 3/8", 1/2", 3/4", 1-1/4", 1-1/2", 2" .

### Accessories and spares



TMVM ... / TFVM ...



TMV ... SS/  
TFV ... SS



Seal kits



# High Pressure



## PVVM



Screw to Connect Male and Female couplings, suitable for High Pressure applications. Equipped with a robust metal-to-metal sealing poppet valve. Maximum Working Pressure: 100 MPa. Connection under pressure: allowed residual in one of the two halves. Interchangeable according to ISO 14540. Available sizes: 1/4", 3/8".

### Accessories and spares



TMP .../TFP ...



Seal kits

## PVSM



Screw to Connect Male and Female couplings, suitable for High Pressure applications. Equipped with a metal-to-metal sealing ball valve. Maximum Working Pressure: 72 MPa. Connection under pressure: allowed residual in one of the two halves. Interchangeable according to ISO 14540. Available in size 3/8".

### Accessories and spares



TMP .../TFP ...



Seal kits

## FFHP



Flat Face Male and Female couplings, suitable for High Pressure applications. Flat valve shut-off system prevents contamination and spillage. Zinc-Nickel plating ensures good resistance to wear and corrosion. Maximum Working Pressure: 72 MPa. Available sizes: 1/4", 3/8".

---

# Oil & Gas / Snap Tite



---

## OGV



Standard screw-to-connect coupling suitable for Oil & Gas applications. Robust sleeve design, poppet valve and ACME connection thread.

Connection under pressure: allowed residual in one of the two halves.

Available sizes: 1-1/2", 2"

---

### Accessories and spares

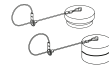

TM OGV ... S/  
TF OGV ... S

---

## OGF



Male and Female couplings, suitable for Oil & Gas applications. Poppet valve designed to help flow and allow connection with TNL parts (free flow) same series. Interchangeable with Faster TNL couplings.

Available sizes: 1/4", 3/8", 1/2", 3/4", 1", 1-1/4", 1-1/2".

---

### Accessories and spares

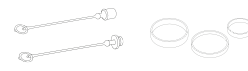

TMH .../TFH ...

Seal kits

---

## TNV



Flat Face Male and Female couplings suitable for Oil & Gas applications.

The Flat Face design guarantees very low spillage and prevents external contamination.

Equipped with locking ball to prevent accidental disconnection.

Interchangeable with Snap-tite 71 series.

Available in sizes: 1/4", 3/8", 1/2", 3/4", 1".

# BOP



## HNV FR



Male and Female couplings with poppet valve shut-off system, Lloyd's certified, suitable for Oil & Gas applications. Thanks to special components and seals, HNVFR couplings are API 16 D certified and suitable for BOP application. Interchangeable according to ISO 7241 Part B.  
Available sizes: 1/2", 3/4", 1"

### Accessories and spares



TMH ... / TFH

## FHV FR



Screw-to-Connect Flat Face couplings, Lloyd's certified, suitable for Oil & Gas applications. Equipped with a safety sleeve to help preventing accidental disconnections due to vibrations. Zinc-Nickel plating. Thanks to special components and seals, FHVFR couplings are API 16 D certified and suitable for BOP application. Connectable with residual pressure in the Male half up to 35 MPa. Faster proprietary profile.  
Available sizes: 3/4", 1"

### Accessories and spares



TM-TF FHV ...

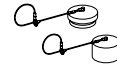

TM FHV ... S/  
TF FHV ... S

## OGV FR



Screw to Connect Male and Female couplings, Lloyd's certified, suitable for Oil & Gas applications. Robust sleeve design, poppet valve and ACME connection thread. Thanks to special components and seals, OGVFR couplings are API 16 D certified and suitable for BOP application. Connection under pressure: allowed residual in one of the two halves.  
Available sizes: 3/4", 1", 1-1/4"

### Accessories and spares

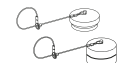

TM OGV ... S/  
TF OGV ... S

# Refrigeration



**RF**



Screw to connect couplings for air conditioning & refrigeration application. Interchangeability according to market driven standards. Available in several versions in steel, brass and with copper sweat braze adaptor

Available in sizes: 1/4", 3/8", 1/2", 3/4", 1".

## Accessories and spares



TMRF .../TFRF ...

**RFL**



Screw to connect female couplings for air conditioning & refrigeration application, low friction sleeve.

The female couplings are equipped with a low friction sleeve in order to reduce connection effort and friction. Fully interchangeable with RF series same size.

Available in sizes: 1/4", 3/8", 1/2", 3/4", 1".

## Accessories and spares



TMRF .../TFRF ...

**RFLS - RFS**



RFLS screw-to-connect female couplings are equipped with a low friction sleeve to reduce connection effort together with an integrated safety sleeve to prevent accidental disconnections. Corresponding male couplings RFS series are characterized by Faster profile interchangeability. Available in sizes: 1/4", 3/8", 1/2", 3/4".

## Accessories and spares



TMRFLS ... /  
TFRFLS ...

---

# Check Valves & Diagnostic

---

## VU



Standard unidirectional check valves, acting as a safety device into hydraulic systems. Standard versions contain a spring set to open the valve at 35 kPa; Normally available with inlet and outlet Female threads. Wide range of calibrations available, from 10 to 950 kPa.

Available sizes: 1/4", 3/8", 1/2", 3/4", 1", 1-1/4", 1-1/2", 2".

---

## VUC



Compact check valves, acting as a safety device into hydraulic systems. Very compact design, assembled with only one piece body. Standard cracking pressure 35 kPa.

Available sizes: 1/4", 3/8", 1/2", 3/4", 1".

---

## DF



Diagnostic Flat Face Male and Female couplings, specifically designed to measure the internal pressure of hydraulic circuits. Male part to be mounted on the hydraulic line, Female part to be connected to gauge instruments.

Interchangeable according to ISO 15171-1.

Available in size 1/4".

---

### Accessories and spares



TFDF 04

---

# Special Solutions

---

## FFC



Flat Face Male and Female cartridge couplings in Stainless Steel (AISI 316) with Viton seals. Self-aligning couplings for MultiFaster. Misalignments up to  $\pm 0.5$  mm and  $\pm 1^\circ$  (angular) are automatically compensated during the connection. Faster proprietary profile.  
Available sizes: 1/4", 3/8", 1/2".

---

## FFHB

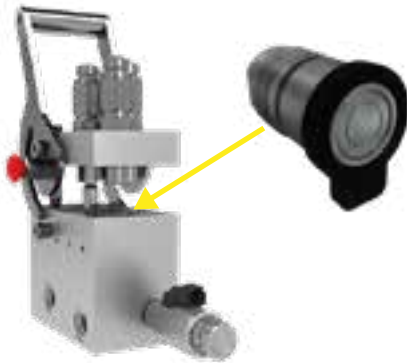

Integrated flat face cartridge, suitable for hydraulic multiconnections and manifolds. Thanks to its special sleeve button it is possible to connect the cartridge with dedicated plate counterpart or with single couplers. The cartridge allows frontal assembly with a dedicated tool. Conforms to ISO 16028 interchange standard.  
Available sizes: 3/8", 1/2", 3/4".

---

### Accessories and spares



FFHB ... TOOL



---

# Automatic Multiconnection

---

## Steel Industry



Multiconnection suitable for steel industry application (Rolling), with automatic alignment system. Rolling is a metal forming process in which metal stock is passed through one or more pairs of rolls to reduce thickness, or to make thickness uniform. The group of rolls is enclosed in a cage. This Multiconnection can be customized with the addition of electrical connectors.

---

## Thermoforming Industry



Multiconnection suitable for thermoforming industry application, with automatic alignment system. Thermoforming is a manufacturing process where a plastic sheet is heated to a pliable forming temperature, formed to a specific shape in a mold, and finally trimmed to create a usable product. This technology is typically employed, other than in the automotive, sanitary and industrial sectors, in the manufacturing of refrigerators. This Multiconnection can be customized with the addition of electrical connectors.

---

## Automotive Engine Test



Multiconnection suitable for End-of-line engine testing. The automatic connection of multiple lines (hydraulic, pneumatic, electrical) allows quick and reliable fill of external media needed to run the test, contributing to a massive reduction of the setup time for the whole process.

---

# MultiFaster for Industrial Applications

---

## M001



MultiFaster 2 lines size 06. Working Pressure 25 MPa. This special MultiFaster is designed for CNC machines applications. CNC machines are highly automated manufacturing tools controlled by a computer. Thanks to this MultiFaster it's possible to pressurize all the hydraulic cylinders which block the pieces with one single maneuver, reducing the overall cycle time.

---

### Accessories and spares

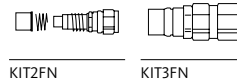

KIT2FN

KIT3FN

---

## P10A



MultiFaster 10 lines. 5 lines size 08, 5 lines size 04. Working Pressure 25 MPa. Flow rate @ 0.2 MPa: 5 lines 70 l/min, 5 lines 20 l/min.

---

### Accessories and spares

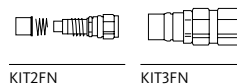

KIT2FN

KIT3FN

---

## P12A



MultiFaster 12lines. 10 lines size 08, 2 lines size 04. Working Pressure 25 MPa. Flow rate @ 0.2 MPa: 10 lines 70 l/min, 2 lines 20 l/min.

---

### Accessories and spares

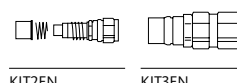

KIT2FN

KIT3FN

---

# MultiFaster for High Pressure



## PH216S



MultiFaster for High Pressure applications.  
2 lines size 16. Working Pressure: 46 MPa.  
Flow rate @ 0.2 MPa: 60 l/min.

---

### Accessories and spares



KITFHB



KIT3FHP

## PH408S



MultiFaster for High Pressure applications.  
4 lines size 08. Working Pressure: 46 MPa.  
Flow rate @ 0.2 MPa: 60 l/min.

---

### Accessories and spares



KITFHB



KIT3FHP

## PH510S



MultiFaster 4 lines for High Pressure applications. 2  
lines size 08, 2 lines size 12. Working Pressure: 46 MPa.  
Flow rate @ 0.2 MPa: 2 lines 60 l/min, 2 lines 105 l/min.

---

### Accessories and spares

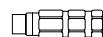

KITFHB



KIT3FHP



Hidrotema

Industrial

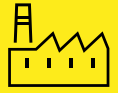

---

## ICONS LEGEND



Connection Under Pressure:  
Allowed Male Half up to W.P.



Connection Under Pressure:  
Allowed Both Halves



Connection Under Pressure:  
Allowed Residual



Connection and disconnection  
under residual pressure both halves



Disconnection Under Pressure:  
Allowed Male Half up to W.P.



Connection Under Pressure:  
Not Allowed

---



# Sleeve Retraction / ISO 7241 - B



## HNV



Male and Female couplings for industrial applications with poppet valve shut-off system. Complete range of sizes available with BSP, NPT and SAE Female threads. Interchangeable according to ISO 7241 Part B.

Available sizes: 1/8", 1/4", 3/8", 1/2", 3/4", 1", 1-1/2", 2".

### Accessories and spares



TMH.../TFH



TMH...S/TFH...S



Seal kits

## HNV brass



Male and Female couplings for industrial applications with poppet valve shut-off system. Brass version available with NBR or Viton seals. Interchangeable according to ISO 7241 Part B.

Available sizes: 1/8", 1/4", 3/8", 1/2", 3/4", 1", 1-1/2".

### Accessories and spares



TMH.../TFH



TMH...S/TFH...S



Seal kits

## HNV stainless steel



Male and Female couplings for industrial applications with poppet valve shut-off system. Stainless Steel version (AISI 316) with Viton seals. Interchangeable according to ISO 7241 Part B.

Available sizes: 1/4", 3/8", 1/2", 3/4", 1", 1-1/2", 2".

### Accessories and spares



TMH.../TFH



TMH...S/TFH...S



Seal kits



# Flat Face / ISO 16028



## FFH



Flat Face Male and Female couplings for industrial applications. Steel version (Mate 1000) with seals in NBR. Interchangeable according to ISO 16028. Available sizes: 1/8", 1/4", 3/8", 1/2", 3/4", 1", 1-1/2".

### Accessories and spares



TAF ...



TMF 38 .../TF 38 ...



TM 2FI .../TF 2FI ...



TM 2FI\_S/TMFFH\_S  
TF 2FL\_S/TFFFH\_S

## 2FFI brass



Flat Face Male and Female couplings for industrial applications. Brass version with seals in Viton. Interchangeable according to ISO 16028. Available in size 1/2".

### Accessories and spares



TM 2FI .../TF 2FI ...



TM 2FI\_S/TF 2FL\_S

## 2FFI stainless steel



Flat Face Male and Female couplings for industrial applications. Stainless Steel version (AISI 316) with Viton seals. Available sizes: 1/4", 3/8", 1/2", 3/4", 1".

### Accessories and spares



TFF 38 ...



TM 2FI .../TF 2FI ...



TM 2FI\_S/TF 2FL\_S

# Screw to Connect /Faster Interchange



## FHV HD



Screw-on flat face couplings, equipped with a double Bearing Ball system and greasing nipple. The Zinc-Nickel plating guarantees a remarkable resistance to corrosion. Connectable by hand up to 35 MPa residual pressure in the male half. No hose torsion during connection and disconnection thanks to the internal bearing system. Equipped with a safety sleeve to prevent accidental disconnections due to vibrations. Available sizes: 1", 1-1/4", 1-1/2".

### Accessories and spares



TM-TF FHV ...

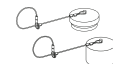

TM FHV ...S/  
TF FHV ...S



Seal kits

## VV



Screw to connect standard couplings, double function sleeve. VV series couplings are very robust and reliable and allow to connect under residual pressure. Thanks to a double function sleeve it's also possible to connect a female part with either VV or NV male halves. Faster proprietary profile. Available sizes: 1/4", 3/8", 1/2", 3/4", 1".

### Accessories and spares



TMV 38 / TFV 38



TMVM ... / TFVM ...



TMV ... SS/  
TFV ... SS

Seal kits

## VVS



Screw to connect couplings for high pressure applications. Couplings commonly used for applications characterized by very high working pressures and peaks. Heavy duty internal components guarantee the maximum safety and reliability. Faster proprietary profile. Interchangeable with Faster VV series. Available sizes: 1/4", 3/8", 1/2", 3/4", 1-1/4", 1-1/2", 2" .

### Accessories and spares



TMVM ... / TFVM ...



TMV ... SS/  
TFV ... SS



Seal kits

# High Pressure



## PVVM



Screw to Connect Male and Female couplings, suitable for High Pressure applications. Equipped with a robust metal-to-metal sealing poppet valve. Maximum Working Pressure: 100 MPa. Connection under pressure: allowed residual in one of the two halves. Interchangeable according to ISO 14540. Available sizes: 1/4", 3/8".

### Accessories and spares



TMP .../TFP ...

Seal kits

## PVSM



Screw to Connect Male and Female couplings, suitable for High Pressure applications. Equipped with a metal-to-metal sealing ball valve. Maximum Working Pressure: 72 MPa. Connection under pressure: allowed residual in one of the two halves. Interchangeable according to ISO 14540. Available in size 3/8".

### Accessories and spares



TMP .../TFP ...

Seal kits

## FFHP



Flat Face Male and Female couplings, suitable for High Pressure applications. Flat valve shut-off system prevents contamination and spillage. Zinc-Nickel plating ensures good resistance to wear and corrosion. Maximum Working Pressure: 72 MPa. Available sizes: 1/4", 3/8".

---

# Oil & Gas / Snap Tite



---

## OGV



Standard screw-to-connect coupling suitable for Oil & Gas applications. Robust sleeve design, poppet valve and ACME connection thread.

Connection under pressure: allowed residual in one of the two halves.

Available sizes: 1-1/2", 2"

---

### Accessories and spares



TM OGV ... S/  
TF OGV ... S

---

## OGF



Male and Female couplings, suitable for Oil & Gas applications. Poppet valve designed to help flow and allow connection with TNL parts (free flow) same series. Interchangeable with Faster TNL couplings.

Available sizes: 1/4", 3/8", 1/2", 3/4", 1", 1-1/4", 1-1/2".

---

### Accessories and spares

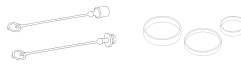

TMH .../TFH ...

Seal kits

---

## TNV



Flat Face Male and Female couplings suitable for Oil & Gas applications.

The Flat Face design guarantees very low spillage and prevents external contamination.

Equipped with locking ball to prevent accidental disconnection.

Interchangeable with Snap-tite 71 series.

Available in sizes: 1/4", 3/8", 1/2", 3/4", 1".

# BOP



## HNV FR



Male and Female couplings with poppet valve shut-off system, Lloyd's certified, suitable for Oil & Gas applications. Thanks to special components and seals, HNVFR couplings are API 16 D certified and suitable for BOP application. Interchangeable according to ISO 7241 Part B.

Available sizes: 1/2", 3/4", 1"

### Accessories and spares



TMH ... / TFH

## FHV FR



Screw-to-Connect Flat Face couplings, Lloyd's certified, suitable for Oil & Gas applications.

Equipped with a safety sleeve to help preventing accidental disconnections due to vibrations. Zinc-Nickel plating. Thanks to special components and seals, FHVFR couplings are API 16 D certified and suitable for BOP application. Connectable with residual pressure in the Male half up to 35 MPa. Faster proprietary profile.

Available sizes: 3/4", 1"

### Accessories and spares



TM-TF FHV ...

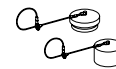

TM FHV ... S/  
TF FHV ... S

## OGV FR



Screw to Connect Male and Female couplings, Lloyd's certified, suitable for Oil & Gas applications. Robust sleeve design, poppet valve and ACME connection thread. Thanks to special components and seals, OGVFR couplings are API 16 D certified and suitable for BOP application. Connection under pressure: allowed residual in one of the two halves. Available sizes: 3/4", 1", 1-1/4"

### Accessories and spares

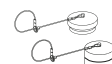

TM OGV ... S/  
TF OGV ... S

# Refrigeration



**RF**



Screw to connect couplings for air conditioning & refrigeration application. Interchangeability according to market driven standards. Available in several versions in steel, brass and with copper sweat braze adaptor

Available in sizes: 1/4", 3/8", 1/2", 3/4", 1".

## Accessories and spares



TMRF .../TFRF ...

**RFL**



Screw to connect female couplings for air conditioning & refrigeration application, low friction sleeve.

The female couplings are equipped with a low friction sleeve in order to reduce connection effort and friction. Fully interchangeable with RF series same size.

Available in sizes: 1/4", 3/8", 1/2", 3/4", 1".

## Accessories and spares



TMRF .../TFRF ...

**RFLS - RFS**



RFLS screw-to-connect female couplings are equipped with a low friction sleeve to reduce connection effort together with an integrated safety sleeve to prevent accidental disconnections. Corresponding male couplings RFS series are characterized by Faster profile interchangeability. Available in sizes: 1/4", 3/8", 1/2", 3/4".

## Accessories and spares



TMRFLS ... /  
TFRFLS ...



# Check Valves & Diagnostic

## VU



Standard unidirectional check valves, acting as a safety device into hydraulic systems. Standard versions contain a spring set to open the valve at 35 kPa; Normally available with inlet and outlet Female threads. Wide range of calibrations available, from 10 to 950 kPa.

Available sizes: 1/4", 3/8", 1/2", 3/4", 1", 1-1/4", 1-1/2", 2".

## VUC



Compact check valves, acting as a safety device into hydraulic systems. Very compact design, assembled with only one piece body. Standard cracking pressure 35 kPa.

Available sizes: 1/4", 3/8", 1/2", 3/4", 1".

## DF



Diagnostic Flat Face Male and Female couplings, specifically designed to measure the internal pressure of hydraulic circuits. Male part to be mounted on the hydraulic line, Female part to be connected to gauge instruments.

Interchangeable according to ISO 15171-1.

Available in size 1/4".

### Accessories and spares



TFDF 04

---

# Special Solutions

---

## FFC



Flat Face Male and Female cartridge couplings in Stainless Steel (AISI 316) with Viton seals. Self-aligning couplings for MultiFaster. Misalignments up to  $\pm 0.5$  mm and  $\pm 1^\circ$  (angular) are automatically compensated during the connection. Faster proprietary profile.  
Available sizes: 1/4", 3/8", 1/2".

---

## FFHB

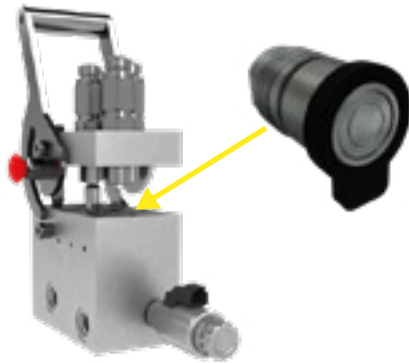

Integrated flat face cartridge, suitable for hydraulic multiconnections and manifolds. Thanks to its special sleeve button it is possible to connect the cartridge with dedicated plate counterpart or with single couplers. The cartridge allows frontal assembly with a dedicated tool. Conforms to ISO 16028 interchange standard.  
Available sizes: 3/8", 1/2", 3/4".

---

### Accessories and spares



FFHB ... TOOL

---

# Automatic Multiconnection

---

## Steel Industry



Multiconnection suitable for steel industry application (Rolling), with automatic alignment system. Rolling is a metal forming process in which metal stock is passed through one or more pairs of rolls to reduce thickness, or to make thickness uniform. The group of rolls is enclosed in a cage. This Multiconnection can be customized with the addition of electrical connectors.

---

## Thermoforming Industry



Multiconnection suitable for thermoforming industry application, with automatic alignment system. Thermoforming is a manufacturing process where a plastic sheet is heated to a pliable forming temperature, formed to a specific shape in a mold, and finally trimmed to create a usable product. This technology is typically employed, other than in the automotive, sanitary and industrial sectors, in the manufacturing of refrigerators. This Multiconnection can be customized with the addition of electrical connectors.

---

## Automotive Engine Test



Multiconnection suitable for End-of-line engine testing. The automatic connection of multiple lines (hydraulic, pneumatic, electrical) allows quick and reliable fill of external media needed to run the test, contributing to a massive reduction of the setup time for the whole process.

---

# MultiFaster for Industrial Applications

---

## M001



MultiFaster 2 lines size 06. Working Pressure 25 MPa. This special MultiFaster is designed for CNC machines applications. CNC machines are highly automated manufacturing tools controlled by a computer. Thanks to this MultiFaster it's possible to pressurize all the hydraulic cylinders which block the pieces with one single maneuver, reducing the overall cycle time.

---

### Accessories and spares

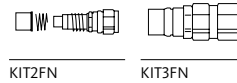

KIT2FN

KIT3FN

---

## P10A



MultiFaster 10 lines. 5 lines size 08, 5 lines size 04. Working Pressure 25 MPa. Flow rate @ 0.2 MPa: 5 lines 70 l/min, 5 lines 20 l/min.

---

### Accessories and spares

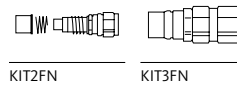

KIT2FN

KIT3FN

---

## P12A



MultiFaster 12lines. 10 lines size 08, 2 lines size 04. Working Pressure 25 MPa. Flow rate @ 0.2 MPa: 10 lines 70 l/min, 2 lines 20 l/min.

---

### Accessories and spares

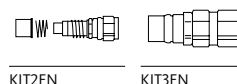

KIT2FN

KIT3FN

# MultiFaster for High Pressure



## PH216S



MultiFaster for High Pressure applications.  
2 lines size 16. Working Pressure: 46 MPa.  
Flow rate @ 0.2 MPa: 60 l/min.

### Accessories and spares

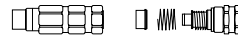

KITFHB

KIT3FHP

## PH408S



MultiFaster for High Pressure applications.  
4 lines size 08. Working Pressure: 46 MPa.  
Flow rate @ 0.2 MPa: 60 l/min.

### Accessories and spares

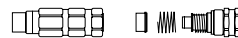

KITFHB

KIT3FHP

## PH510S



MultiFaster 4 lines for High Pressure applications. 2  
lines size 08, 2 lines size 12. Working Pressure: 46 MPa.  
Flow rate @ 0.2 MPa: 2 lines 60 l/min, 2 lines 105 l/min.

### Accessories and spares



KITFHB

KIT3FHP





**Hidrotema**

**Mobile & Construction  
Equipment**



---

Faster offers a dedicated range of products for Mobile & Construction Equipment, suitable for both Light Equipment, such as Skid Steer and Multiutilities, and Heavy-duty application.

Faster has developed several solutions for the Mobile & Construction Equipment market, including Flat Face couplings, robust and reliable Screw to Connect couplings, Casting solutions with integrated pressure release system and MultiFaster for connection of multiple lines. For applications that are typical

in the construction market, quick-release couplings are required to adapt themselves to work in dusty environments with sand and dirt. It is very important that the seals used are specifically studied and created from polymer blends able to sustain the deterioration and consumption induced by the hostile work conditions.



## ICONS LEGEND



Connection Under Pressure:  
Allowed Male Half up to W.P.



Connection Under Pressure:  
Allowed Both Halves



Connection Under Pressure:  
Allowed Residual



Connection and disconnection  
under residual pressure both halves



Disconnection Under Pressure:  
Allowed Male Half up to W.P.



Connection Under Pressure:  
Not Allowed

# Heavy Equipment

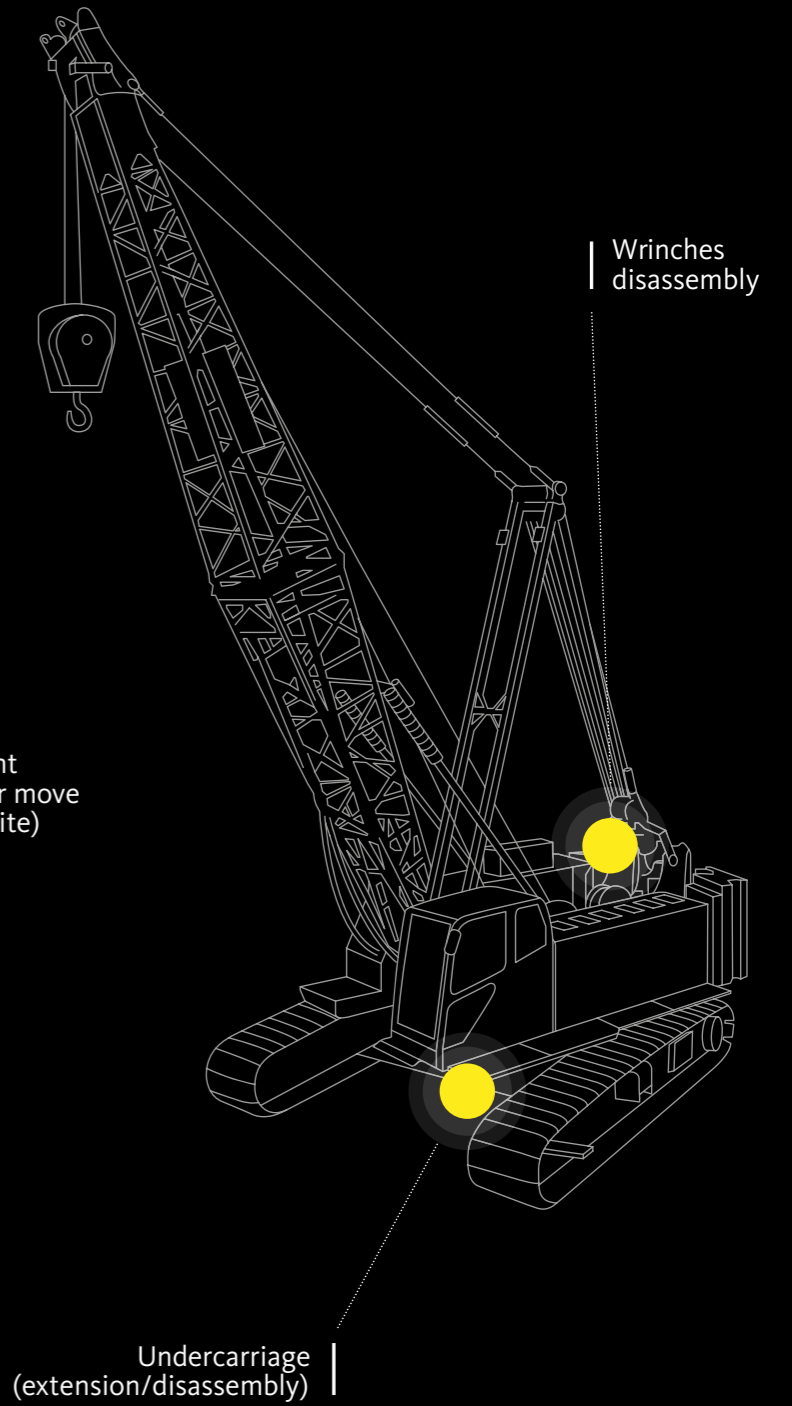
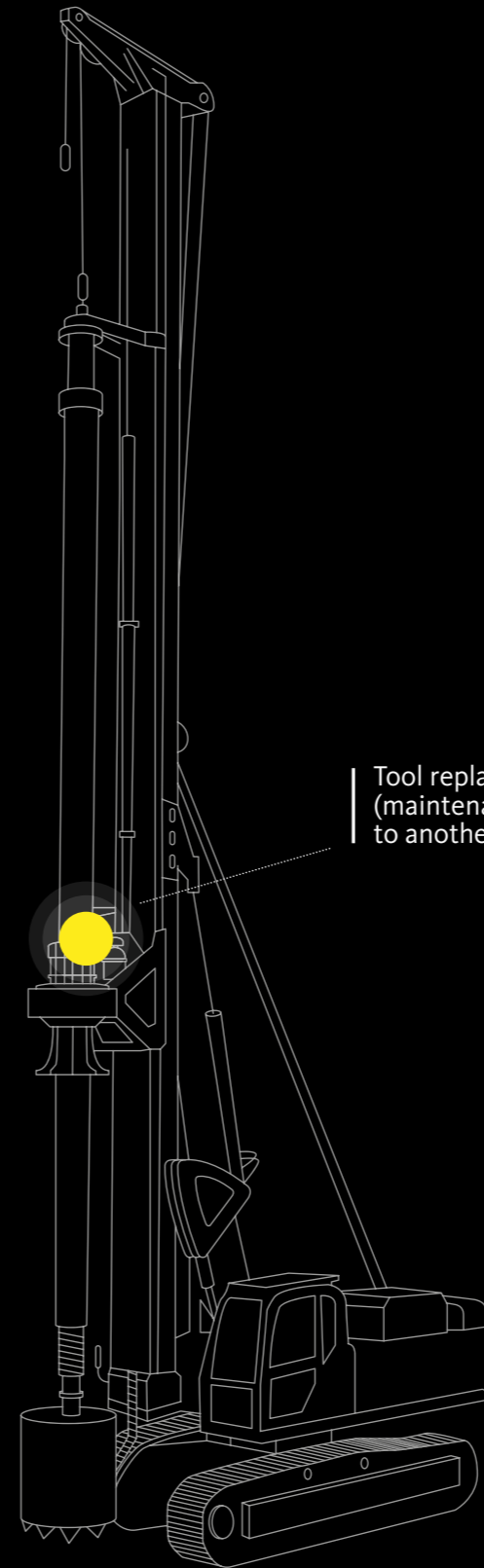
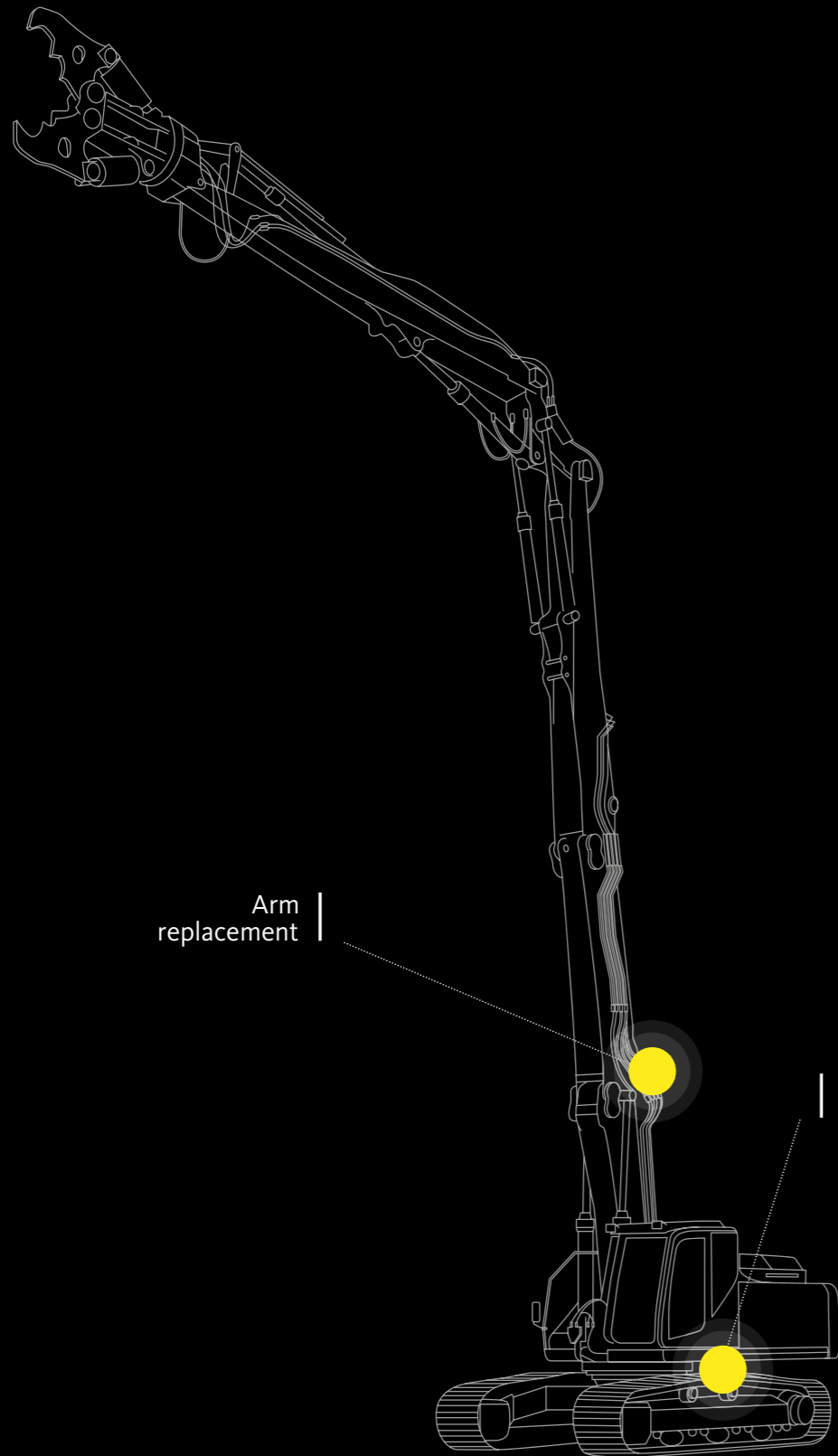

---

# Light Equipment

Attachment replacement

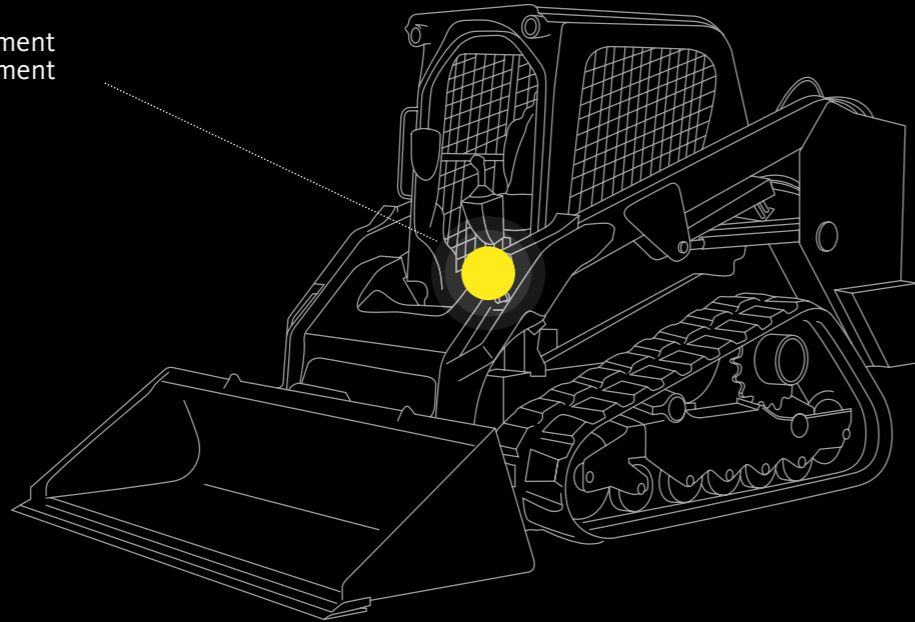

Attachment replacement

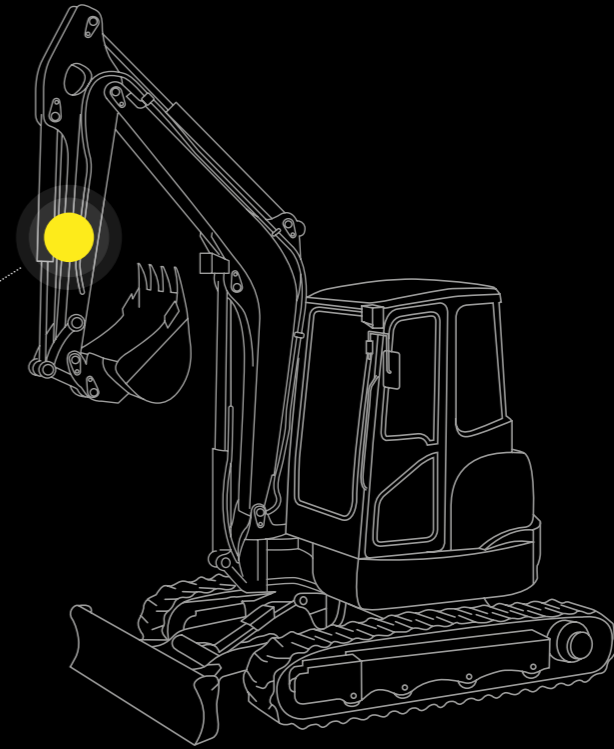

Attachment replacement

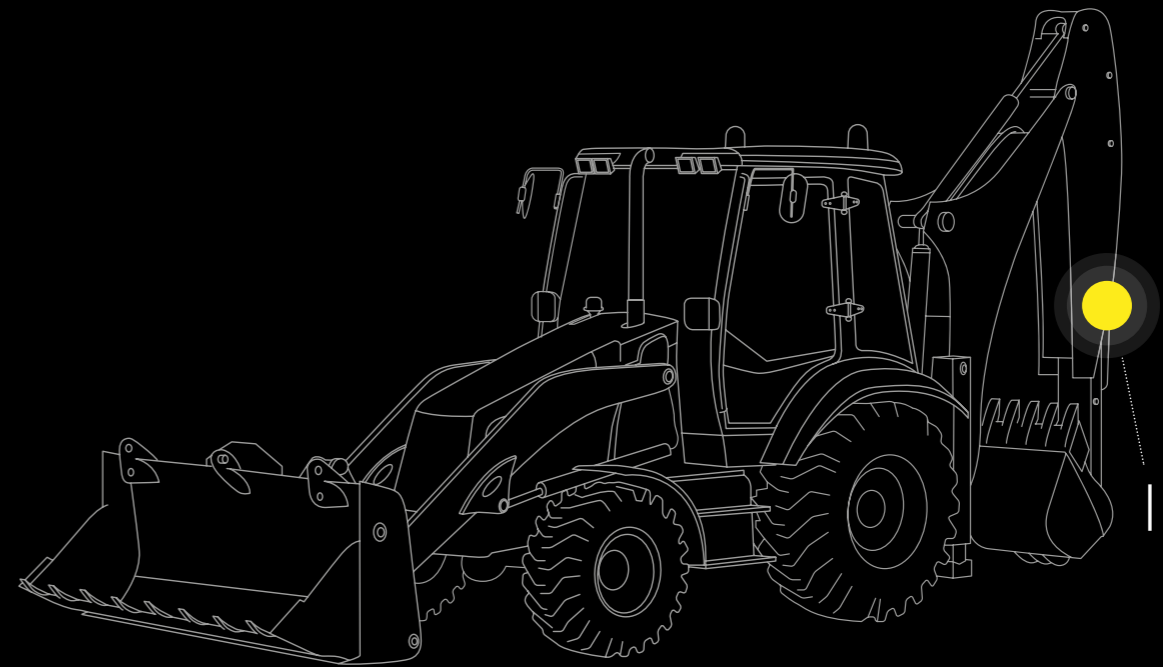

# Flat Face



## FFH



Flat face Male and Female couplings.  
The flat valve shut-off system prevents contamination and spillage.  
Real maximum working pressure of 35 MPa and Zinc-Nickel plating.  
Available sizes: 1/8", 1/4", 3/8", 1/2", 5/8", 3/4", 1".  
Interchangeable according to ISO 16028.  
Size 1/8" has surface treatment in Mate 500 (CrIII) and it is not ISO interchangeable.

### Accessories and spares

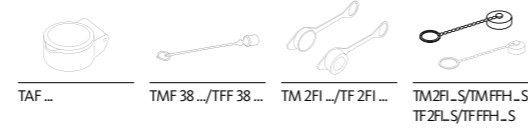

TAF ... TMF 38 .../TFF 38 ... TM 2FI .../TF 2FI ... TM2FI\_S/TMFFH\_S TF2FL\_S/TFFFH\_S

## 3FFH



Flat face Male and Female couplings.  
The flat valve shut-off system prevents contamination and spillage.  
Real maximum working pressure of 35 MPa and Zinc-Nickel plating.  
Connectable under residual pressure.  
It is possible to couple either a 3FFH Female half under pressure with a FFH Male half, or a 3FFH Male half under pressure with a FFH Female half.  
Available sizes: 3/8", 1/2", 5/8", 3/4".  
Interchangeable according to ISO 16028.

The 1/2" size, one of the most popular diameters used for compact excavators and tracked/wheeled loaders equipment, is now available in a compact version (3FFK), to suit applications characterized by longitudinal space constraints. 3FFK offers same technical performances as 1/2" male couplings belonging to 3FFH series, with a 25 mm shorter body.

### Accessories and spares

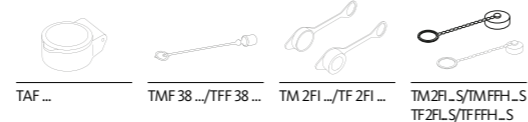

TAF ... TMF 38 .../TFF 38 ... TM 2FI .../TF 2FI ... TM2FI\_S/TMFFH\_S TF2FL\_S/TFFFH\_S

## FSH



Flat face Female couplings, equipped with sector latching technology.  
The sector latching system enables to effectively tackle the Brinelling effect, provoked by high frequency impulsive pressures.  
Real maximum working pressure of 35 MPa and Zinc-Nickel plating.  
Connectable under residual pressure in the Male half when coupled with a 3FFH Male coupling.  
Available sizes: 3/8", 1/2", 3/4", 1".  
Interchangeable according to ISO 16028.

### Accessories and spares



TAF ... TMF 38 .../TFF 38 ... TM 2FI ... TM2FI\_S/TM2FN38\_S

## FLV



Screw-on Flat Face couplings, with extremely compact and robust design.  
Ideal for applications in which a flat face connection is required and there are no significant residual pressures to manage.  
Available sizes: 3/8", 1/2", 3/4", 1".

### Accessories and spares

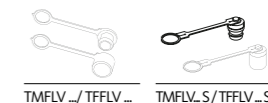

TMFLV .../TFFLV ... TMFLV\_S/TFFLV\_S

# Screw to Connect



## CVV



Screw-to-Connect Male and Female couplings, suitable for general purpose applications. High resistance to pressure and flow impulses. Connectable under residual pressure. Available sizes: 1/4", 3/8", 1/2", 3/4", 1", 1-1/2". Interchangeable according to ISO 14541 standard only for sizes 1/4", 3/8", 1/2", 3/4".



### Accessories and spares

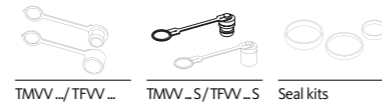

TMVV.../TFVV...

TMVV...S/TFVV...S

Seal kits

## VVS



Screw-to-Connect Male and Female couplings, suitable for applications characterized by high working pressures and peaks. Safe and reliable thanks to the heavy duty internal components. Available sizes: 1/4", 3/8", 1/2", 3/4", 1", 1-1/4", 1-1/2", 2".



### Accessories and spares

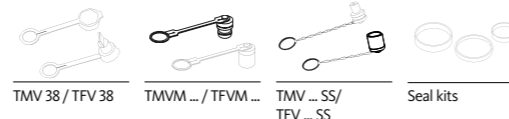

TMV 38 / TFV 38

TMVM... / TFVM...

TMV...SS/TFV...SS

Seal kits

## OGVST



Screw to connect couplings for Oil & Gas application, market interchange. Equipped with a marker that confirms the complete connection and a longer locking sleeve for an improved engagement. Robust sleeve design, poppet valve and ACME connection thread. Available sizes: 1-1/2", 2".



### Accessories and spares



TM OGV...S/  
TF OGV...S

## FHV



Screw-to-Connect Flat Face couplings, suitable for heavy duty applications. Equipped with a safety sleeve to help preventing accidental disconnections due to vibrations. Equipped with a clear and intuitive visual check system, confirming the connection has occurred (green ring) or not (red ring). No hose torsion during connection and disconnection thanks to the internal bearing system. The Zinc-Nickel plating guarantees a remarkable resistance to corrosion. Thanks to its peculiar design, FHV couplings can also be connected and disconnected entirely by hand, without any tools. Connectable with residual pressure in the Male half up to 35 MPa. Working Pressure up to 53 MPa and flow rate up to 1000 l/min. Available sizes: 3/8", 1/2", 3/4", 1", 1-1/4", 1-1/2", 2".



### Accessories and spares

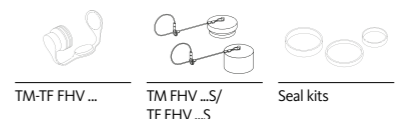

TM-TF FHV...

TM FHV...S/  
TF FHV...S

Seal kits

---

# Castings Solutions



---

## Auxiliary Lines Block (3 ports)



Castings with couplings for construction equipment. The first cast iron block ever designed allowing a quick connection and disconnection of attachments for skid steer loaders and other construction equipment machines.

Cartridges share all the benefits of the FFH series technology. The decompression feature allows to connect the circuit with residual pressure on both ends. Higher flow capability is guaranteed when using 3/4" cartridges instead of 1/2" (both the sizes fit into the same block).

---

## Auxiliary Lines Block with FFH Swivel



This Auxiliary Lines Block with FFH Swivel represents an integration of Taimi swivel connectors and Faster's best technologies.

For tough Construction Equipment applications like mulchers, characterized by a continuous up-down movement, rotation of hoses under pressure can heavily affect durability of quick release couplings, which shouldn't be subject to a prolonged mutual rotation of the bodies when connected.

The development of special block cartridges equipped with rear swivel connectors allows to prevent mutual rotation and increases substantially quick couplings working life.

Due to the presence of rear swivels the traditional pressure relief mechanism of 4BD blocks has been replaced by a pull-knob lever activation.

---

## Auxiliary Lines Block (3+2 HF)



5 Lines blocks make machines more versatile and suitable for a wide range of attachments thanks to 5 quick-couplings hosted in one single casting: two couplings 1/2", two couplings 3/4" for high flow applications and one 3/8" to connect drain lines. The blocks can be hooked up to the machine hydraulic circuit by means of 2 input ports. Hydraulic decompression of the 1/2" lines is performed through the same patented system implemented on the 3-ports auxiliary lines blocks, whereas decompression of the 3/4" lines is achieved through a manual activation. Items shown into this section are off the shelf products not requiring any further design development or investment for production tools.



---

# MultiFaster



---

## PC206



MultiFaster, 2 lines, size O6.  
MultiFaster compact. It allows connection with mobile plate or stand-alone counterpart couplings, 2 lines 3/8".

The disconnection of stand-alone counterpart couplings is made by dedicated push buttons. This feature can be extended to all MultiFaster range.

---

## PH510 S



MultiFaster 4 lines for High Pressure applications.  
2 lines size O8, 2 lines size 12. Working Pressure: 46 MPa.  
Flow rate @ 0.2 MPa: 2 lines 60 l/min, 2 lines 105 l/min.

---

## MultiGrease



MultiFaster with special cartridge for central lubrication system and an electrical connector (7 pins) included. 2 lines, size 1/2".

This feature (special cartridge equipped with shunt system) can be extended to all MultiFaster range.

---

## M116



This compact block represents an interesting example of use of FFHB cartridges series, recently launched on the market by Faster. Equipped with two ISO 16028 cartridges 3/8", it provides a coupling solution to a tiltrotator hitch for auxiliary lines (e.g.: grippers, or any kind of hydraulic attachment). A linear engagement mechanism studied by the machine manufacturer ensures the correct alignment between cartridges during connection and disconnection operations. Compactness, reliability, robustness and ease of maintenance ensured by the front installation are main benefits of this solution. A wide range of blocks could be developed for similar applications, exploiting the advantages offered by FFHB cartridges, available in 3/8", 1/2" and 3/4" sizes.



Hidrotema

Agriculture



---

# Tractor

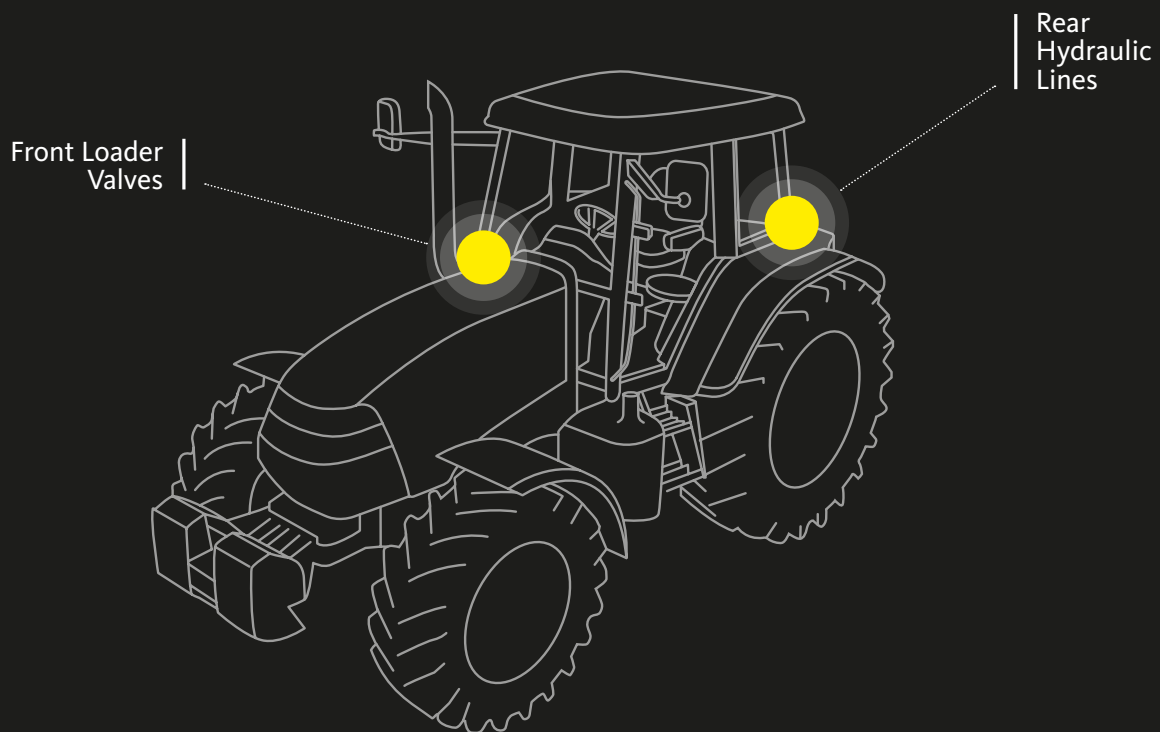

---

# Combine

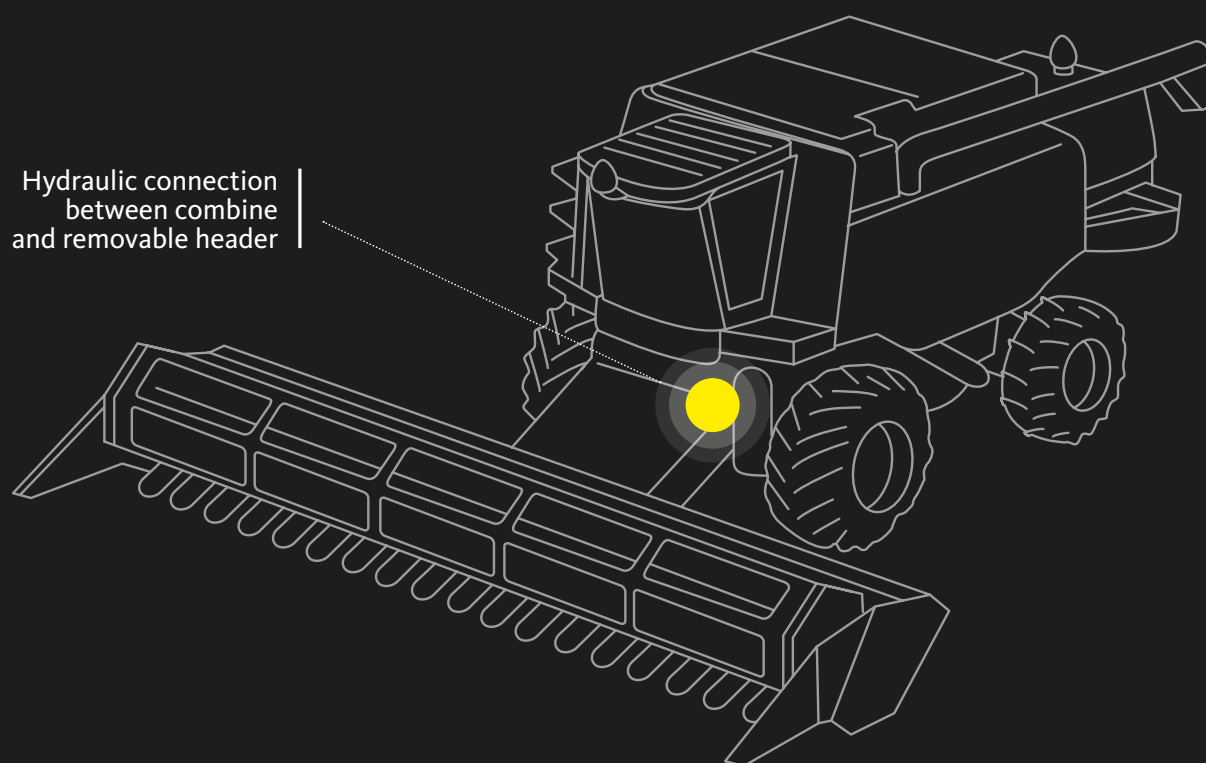

---

## ICONS LEGEND



Connection Under Pressure:  
Allowed Male Half up to W.P.



Connection Under Pressure:  
Allowed Both Halves



Connection Under Pressure:  
Allowed Residual



Connection and disconnection  
Under Residual Pressure both halves



Connection Under Pressure:  
Allowed Male Half up to W.P.



Connection Under Pressure:  
Not Allowed

---

---

# Rear Hydraulic Lines

---

Lines to connect the hydraulic circuit to rear attachments, in order to power them. Some attachments may also require the «power beyond» configuration. Oil flows from the female couplings on the tractor to the male on the attachment, and returns.





---

# Single Couplings

---

- **SLEEVE RETRACTION**
- **PUSH - PULL**
- **HIGH FLOW**

Faster offers a wide variety of couplings specifically designed for agriculture.

All single couplings solutions for agriculture are size 1/2" and interchangeable according to ISO 7241 part A.

Standard features for the Agriculture range are: carbon steel as material, CrIII as surface treatment, poppet valve and a maximum operating pressure of 25 MPa.

# Sleeve Retraction



**NV** |  |

Male and Female couplings with poppet valve shut-off system.  
Flow rate @ 0.2 MPa: 75 l/min.



## Accessories and spares

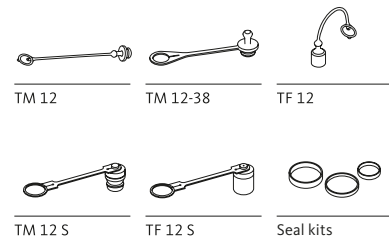

**3CPV** |  |

Female couplings designed for panel mounting installation and connection to flexible hoses.  
Connectable with male under residual pressure.  
Flow rate @ 0.2 MPa: 75 l/min.  
Breakaway function.



## Accessories and spares

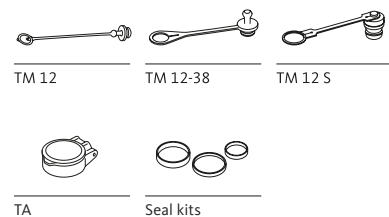

# Push-Pull



## 6DNPV | |



Push-Pull female couplings for rigid mounting connectable with male and female under pressure, disconnectable under pressure with low effort. Equipped with one or two oil collecting ports to collect clean oil and reduce spillage. Flow rate @ 0.2 MPa: 50 l/min.

### Accessories and spares



TARV 34



Seal kits



Oil Collecting System



## 3CKHF



Male and female compact Push-Pull couplings for agriculture connectable with male under residual pressure.  
Maximum flow rate: 250 l/min.  
Reduced dimensions: 15 mm shorter.  
Breakaway function.

### Accessories and spares



TM 12

TM 12-38

TA



TM 12 S

TAID 12

Seal kits



Oil Collecting System

## 4SKHF



Male and female compact Push-Pull couplings for agriculture connectable under residual pressure in both male and female side.  
Maximum flow rate: 250 l/min.  
Reduced dimensions: 15 mm shorter.  
Breakaway function.

### Accessories and spares

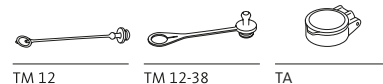

TM 12

TM 12-38

TA



TM 12 S

TAID 12

Seal kits



Oil Collecting System

---

## Rear Hydraulic Lines

---

# Power Beyond

---

Full set of flat face couplings for Power Beyond rear attachments, sizes in accordance with class 1 to 3 of ISO 17567 standard.

Power Beyond attachments allow the tractor to receive pressure feedback from the field through load signal line, in order to adjust oil flow and optimize performances.

# Castings



## Manifold Block |

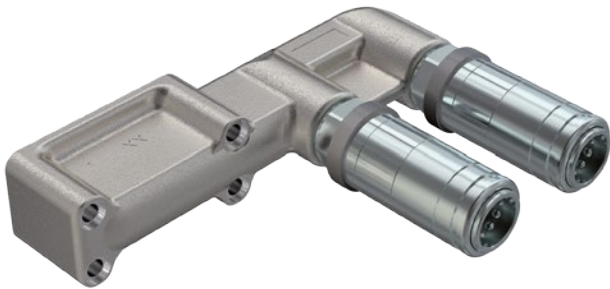

Cast iron block with 1/2" couplings screwed on.  
 Flow rate @ 0,2 MPa: up to 50 l/min.  
 Connection under pressure allowed depending on the mounted coupling.  
 Possible configuration: 3CFPV, 4SRPV, 6DNPV and High Flow couplings.

### Accessories and spares

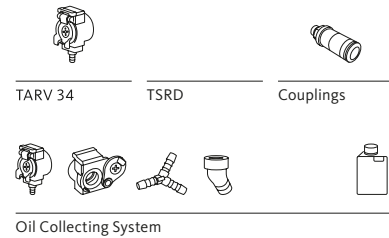

## Semi Integrated Block |

Cast iron blocks equipped with two semi integrated cartridges, available both poppet valve ISO 7241 part A and flat face ISO 16028. Available size: 1/2" and 3/4". The same block is suitable for both ISO A and Flat Face cartridges, easy interchangeable to ensure flexibility. Push-pull connection. Great ease to connect and disconnect agricultural implements thanks to relief of internal residual pressure ensured by one dedicate lever for each line. Breakaway feature. Replacement of the lever does not require disassembling of the block.

### Accessories and spares

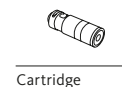



## Fully-integrated Cartridge



Cast iron block with integrated 1/2" cartridge.

Flow rate @ 0,2 MPa: up to 55 l/min.

Connection and disconnection under pressure allowed. Castings available with different configurations: series 4 (connection assisted by lever), series 5 (connection assisted by lever, no male depressurisation while disconnecting) and series 6 (no need of lever).

### Accessories and spares



Cartridge



Mask Series 5



4BM TA D

## Fully-integrated Universal Cartridge



Cast iron block with fully integrated cartridges, connection assisted by lever.

Possible to fit either poppet or flat face cartridges in 3 different sizes: 1/2", 5/8" or 3/4".

Flow rate @ 0,2 MPa: 50 l/min for size 1/2".

Connection and disconnection under pressure allowed.

### Accessories and spares



Cartridge



Dust cap

---

# Front Loaders

---

Lines to connect the hydraulic circuit to front loader attachments to power them. The number of lines varies depending on the number of functions required. Very often there are also electrical connections. Multifaster are the best solution for this type of application, granting comfort and compactness.

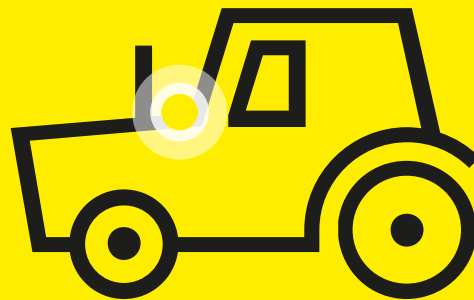

---

# Multifaster for Front Loaders

---

Multifaster are the market reference to connect multiple lines, allowing an effortless connection even with residual pressure in the system. Each product entails a different combination of elements, such as number of lines, coupling size, lever and electrical connectors. The number of lines varies according to the functions performed by the attachment. Tractor front loaders are a typical application for Multifaster.

# MultiFaster



## PC206



MultiFaster compact. It allows connection with mobile plate or stand-alone counterpart couplings, 2 lines size o6.

The disconnection of stand-alone counterpart couplings is made by dedicated push buttons.

This feature can be extended to all MultiFaster range.

### Accessories and spares



KIT3FN



Seal kits

## P508



MultiFaster 4 lines, size o8.

*A brand new feature added to our MultiFaster: the automatic dust cover.*

*A new addition applied to ease and facilitate the connection, giving the user the possibility to automatically open the dust cover, adding more comfort to the manouvre.*

*This system is patented and soon a kit with this solution will be available.*

### Accessories and spares



KIT3FN



KIT2FN



Seal kits

Full set of flat face couplings for Power Beyond rear attachments.

Faster offer for Power Beyond covers all ports composing the Power Beyond configuration:

<b>Load Signal Port</b>	<b>Drain Port</b>
<b>Return Port</b>	<b>Pressure Port</b>

Sizes in accordance with class 1 to 3 of ISO 17567 standard.

**Class 1** – Up to 45 l/min

**Class 2** – 45 to 74 l/min

**Class 3** – 74 to 100 l/min

**Class 4** – 100 to 220 l/min

## Faster couplings range for Power Beyond applications

### Flow Class 1

Up to 45 l/min

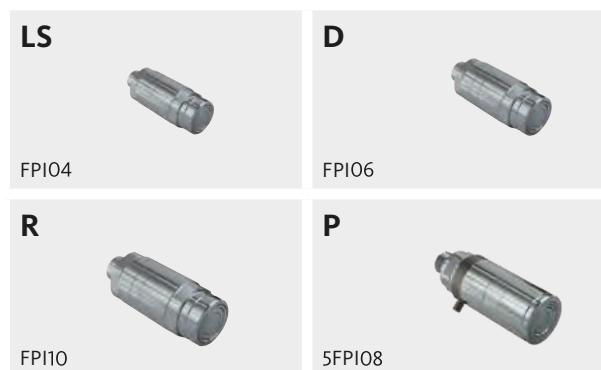

### Flow Class 2

45 to 74 l/min

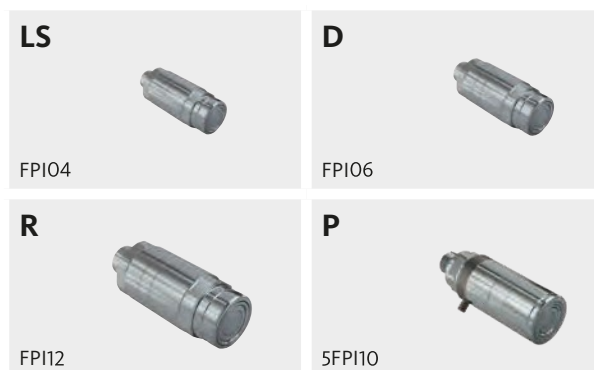

### Flow Class 3

74 to 100 l/min

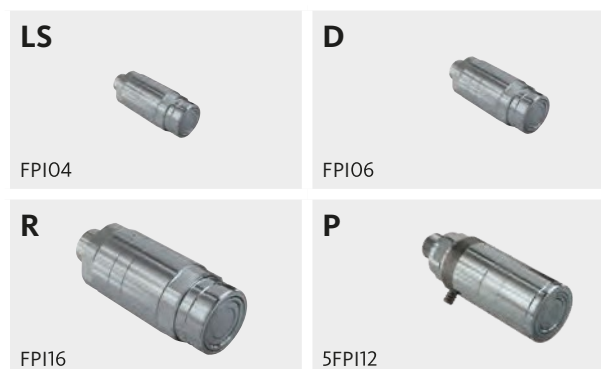

### Flow Class 4

100 to 220 l/min



---

# Harvester/ Combine

---

Combine/harvester machines combine in one single process three harvesting operations: reaping, threshing and winnowing. Combines are equipped with removable heads, each of them designed for a specific crop. Removable heads can be hydraulically connected and disconnected by simply using Multifaster.



---

# Multifaster for Harvesting Applications

---

Faster offers a range of Multifaster specifically designed for harvesting applications.

Multifaster ensure a safe and quick connection and disconnection between the header and the harvester. This allows to easily dismantle and transport the harvester from one field to another. The Multifaster allows a very quick and safe connection and disconnection of the header, which can be replaced according to the operation that needs to be performed by the operator.



# MultiFaster



## PC206



MultiFaster compact. It allows connection with mobile plate or stand-alone counterpart couplings, 2 lines size o6.

The disconnection of stand-alone counterpart couplings is made by dedicated push buttons. This feature can be extended to all MultiFaster range.

---

### Accessories and spares



KIT3FN



Seal kits

## P508

Multifaster 4 lines, size o8.  
*A brand new feature added to our MultiFaster: the automatic dust cover. A new addition applied to ease and facilitate the connection, giving the user the possibility to automatically open the dust cover, adding more comfort to the manouvre. This system is patented and soon a kit with this solution will be available.*

---

### Accessories and spares



KIT3FN



KIT2FN



Seal kits

---

## P608



Multifaster 6 lines, size o8.  
Flow rate @ 0.2 MPa: 70 l/min.  
Possible to mount 2 electrical  
connectors.

### Accessories and spares



KIT3FN



KIT2FN



Seal kits

## PSA06



Multifaster 4 lines, size o6.  
Can be connected and disconnected  
both as a standard multifaster or with  
single lines. Single lines identified by  
switches of different colours.  
Interchangeable with PSo6.  
Equipped with dust cover with rolls to  
ensure perfect sealing when not  
connected.

### Accessories and spares



KIT3FN



KIT2FN



Seal kits

# MultiFaster



## PLV



Multifaster 5 lines. 3 lines size o6,  
2 lines size o9 , 1 housing for electrical  
connector.

Working pressure 22 Mpa.

Flow rate @ 0.2 MPa: 3 lines 20 l/min,  
2 lines 35 l/min.

### Accessories and spares



KIT3FN



KIT2FN



Seal kits

## PLK



Multifaster 5 lines. 2 lines size o6,  
3 lines size o9 , 1 housing for electrical  
connector.

Working pressure 25 Mpa.

Flow rate @ 0.2 MPa: 2 lines 20 l/min,  
3 lines 35 l/min.

### Accessories and spares



KIT3FN



KIT2FN



Seal kits

## 3PLX

Multiconnection 2 lines dash 04 and 2 lines dash 08, with 3 empty seats suitable for electrical connectors. Flat face couplers, CrIII plated. Plate available in two versions: aluminum natural color sandblasted finish, and black painted. Multiconnection is MARKET interchangeable, suitable for Claas combine application.

### Accessories and spares



KIT3FN



KIT2FN



Seal kits

## Automatic Connection

MultiFaster suitable for Harvesting, with automatic alignment system. Fixed plate designed to self-align with mobile plate to complete connection. This kind of product allows the operator to complete the connection with safety, comfort and time saving. This MultiFaster can be customized with addition of electrical connectors.

